

## DISASSEMBLY

### NOTICE:

When using a vise, do not overtighten it.

#### 1. MEASURE PS VANE PUMP ROTATING TORQUE

- Check that the pump rotates smoothly without abnormal noise.
- Using a torque wrench, check the pump rotating torque.

**Rotating torque:**

**0.25 N·m (2.5 kgf·cm, 2.2 in.-lbf) or less**

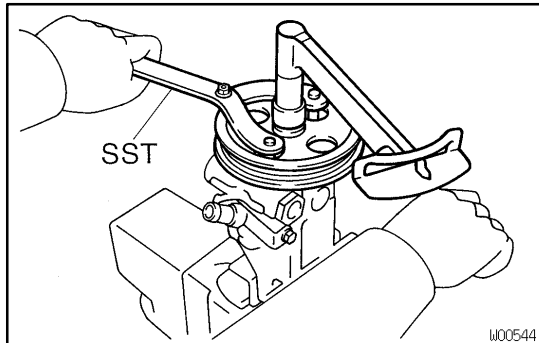

#### 2. REMOVE VANE PUMP PULLEY

Using SST to stop the pulley rotating, remove the pulley set nut.

SST 09960-10010 (09962-01000, 09963-01000)

#### 3. REMOVE SUCTION PORT UNION

- Remove the 2 bolts.
- Remove the O-ring from the union.

#### 4. REMOVE PRESSURE PORT UNION, FLOW CONTROL VALVE AND SPRING

Remove the O-ring from the union.

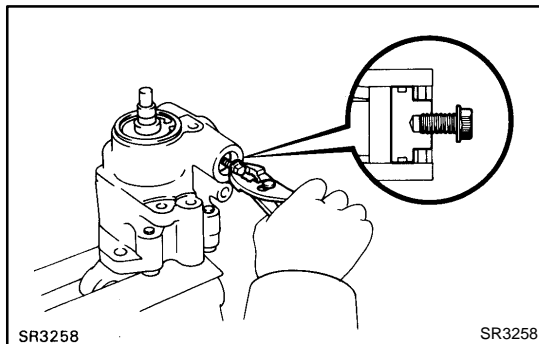

#### 5. REMOVE SPRING SEAT

- Using snap ring pliers, remove the snap ring from the front housing.
- Temporarily install a bolt to the seat and pull it out together with the seat.

### HINT:

Use a bolt with diameter 6 mm (0.24 in.) and pitch 1.0 mm (0.039 in.).

- Remove the O-ring from the seat.

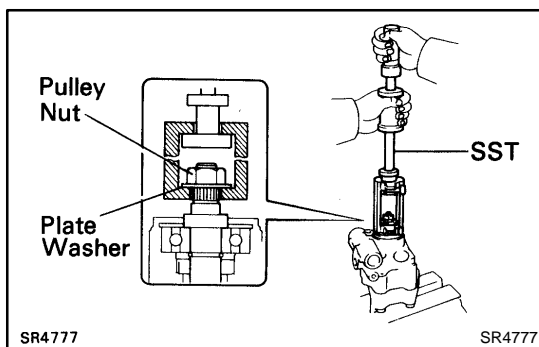

#### 6. REMOVE VANE PUMP SHAFT WITH BEARING

- Using snap ring pliers, remove the snap ring from the front housing.
- Temporarily install a appropriate plate washer and the pulley set nut to the pump shaft.
- Using SST, pull out the pump shaft with the bearing.

SST 09910-00015 (09911-00011, 09912-00010)

#### 7. REMOVE REAR BRACKET

- Remove the 4 bolts.
- Remove the O-ring from the rear bracket.

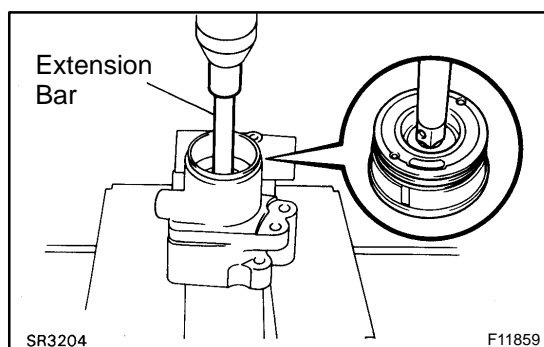
**8. REMOVE WAVE WASHER****9. REMOVE SIDE FRONT PLATE, CAM RING, VANE PUMP ROTOR, VANE PLATES AND SIDE REAR PLATE**

- (a) Using an extension bar and press, press out the side front plate, cam ring, rotor, vane plates and side rear plate as an assembly.
- (b) Remove the O-ring from the side rear plate.
- (c) Remove the cam ring, rotor and the 10 vane plates.

**NOTICE:**

**Take care not to drop the vane plate.**

- (d) Remove the shorter straight pin from the side front plate.
- (e) Remove the 2 O-rings from the side front plate.
- (f) Using pliers, remove the longer straight pin from the front housing.