

INSTALLATION

1. INSTALL STEERING COLUMN ASSEMBLY

- (a) Torque the 4 column assembly set nuts.
Torque: 25 N·m (260 kgf-cm, 19 ft-lbf)
- (b) Connect the connectors.

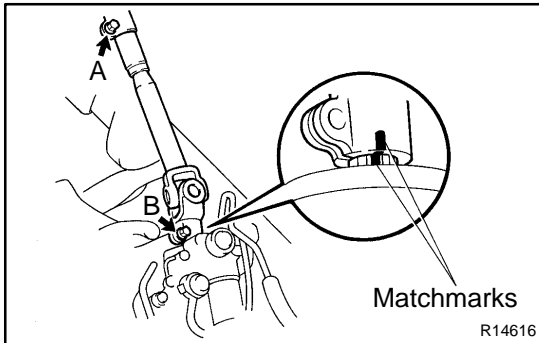

2. INSTALL INTERMEDIATE SHAFT

Temporarily tighten the bolt A.

3. CONNECT INTERMEDIATE SHAFT

- (a) Align the matchmarks on the intermediate shaft and control valve shaft.
- (b) Torque the bolt B.
Torque: 35 N·m (360 kgf-cm, 26 ft-lbf)
- (c) Torque the bolt A.
Torque: 35 N·m (360 kgf-cm, 26 ft-lbf)

4. INSTALL SPIRAL CABLE

(See page [BE-26](#))

5. INSTALL COMBINATION SWITCH

- (a) Tighten the 4 screws.
- (b) Connect the airbag connector.
- (c) Connect the connectors.

6. INSTALL THESE PARTS:

(See page [BO-92](#))

- No. 2 heater to register duct
- No. 1 under cover
- Lower finish panel LH
- No. 1 lower finish panel
- End pad

7. INSTALL UPPER AND LOWER COLUMN COVERS

Tighten the 3 screws.

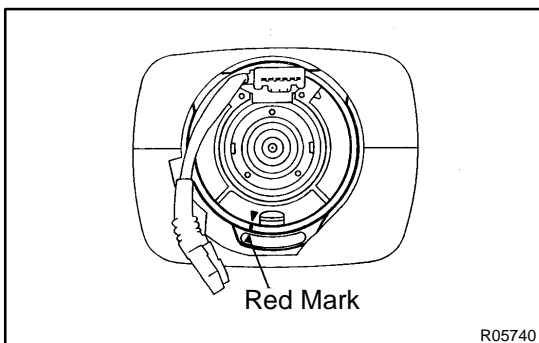

8. CENTER SPIRAL CABLE

- (a) Check that the front wheels are facing straight ahead.
- (b) Turn the spiral cable counterclockwise by hand until it becomes harder to turn the cable.
- (c) Then rotate the spiral cable clockwise about 3 turns to align the red mark.

HINT:

The spiral cable will rotate about 3 turns to either left or right of the center.

9. INSTALL STEERING WHEEL

- (a) Align the matchmarks on the wheel and main shaft.
- (b) Torque the wheel set nut.

Torque: 35 N·m (360 kgf-cm, 26 ft-lbf)

- (c) Connect the connector.

10. INSTALL STEERING WHEEL PAD**NOTICE:**

- Make sure the wheel pad is installed to the specified torque.
- If the wheel pad has been dropped, or there are cracks, dents or other defects on the case or connector, replace the wheel pad with a new one.
- When installing the wheel pad, take care that the wiring does not interfere with other parts and is not pinched between other parts.

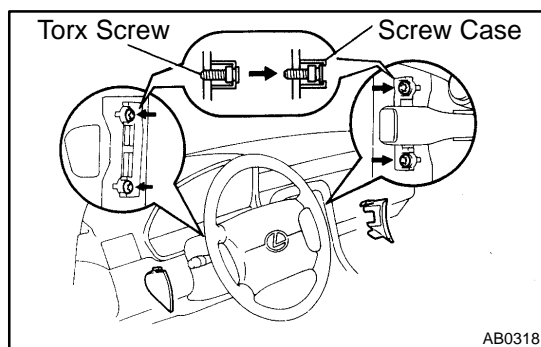

- (a) Connect the airbag connector.
- (b) Install the pad after confirming that the circumference groove of the torx screws is caught on the screw case.
- (c) Using a torx socket wrench, torque the 4 torx screws.

Torque: 9.0 N·m (92 kgf-cm, 80 in.-lbf)

11. CHECK STEERING WHEEL CENTER POINT