

INSTALLATION

1. INSTALL LOWER HIGH-TENSION CORD COVER

Install the high-tension cord cover with the stud bolt.

Torque: 5.5 N·m (55 kgf·cm, 48 in.-lbf)

2. INSTALL RH HIGH-TENSION CORD CLAMPS

- (a) Install the cord clamp to the front high-tension cord clamp.

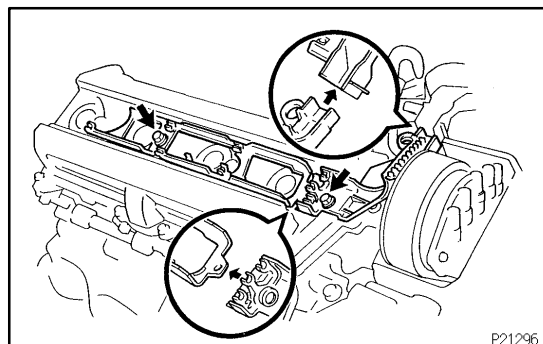

- (b) Install the front and rear high-tension cord clamps with the 2 bolts.

Torque: 5.5 N·m (55 kgf·cm, 48 in.-lbf)

HINT:

Place the front and rear ends of the front high-tension cord clamp on the rear high-tension cord clamp and lower high-tension cord cover.

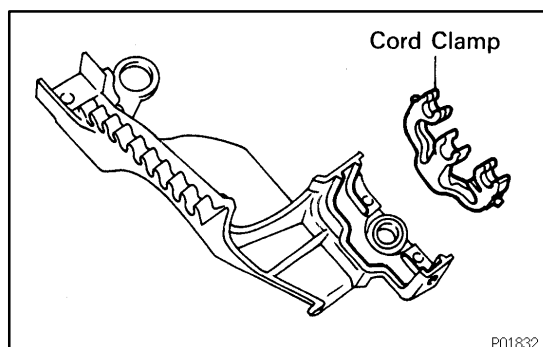

3. INSTALL LH HIGH-TENSION CORD CLAMPS

- (a) Install the cord clamp to the front high-tension cord clamp.

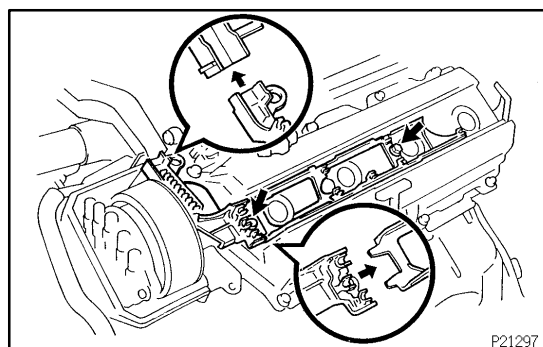

- (b) Install front and rear high-tension cord clamps with the 2 bolts.

Torque: 5.5 N·m (55 kgf·cm, 48 in.-lbf)

HINT:

Place the front and rear ends of the front high-tension cord clamp on the rear high-tension cord clamp and lower high-tension cord cover.

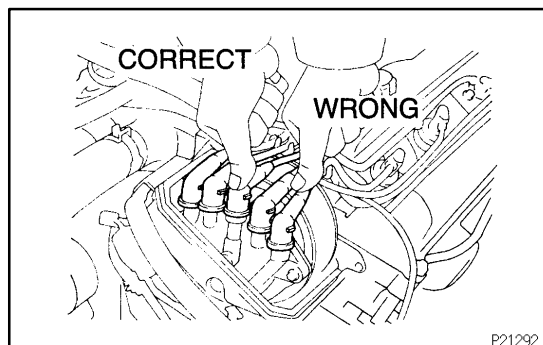

4. INSTALL HIGH-TENSION CORDS

- (a) Connect the high-tension cords to the spark plugs and distributor caps.

NOTICE:

Install the high-tension cord by pressing on the correct place as shown in the illustration. If not done this way, the high-tension cord will interfere with the camshaft timing pulley.

- (b) Secure the high-tension cords with the cord clamps as shown in the illustration.

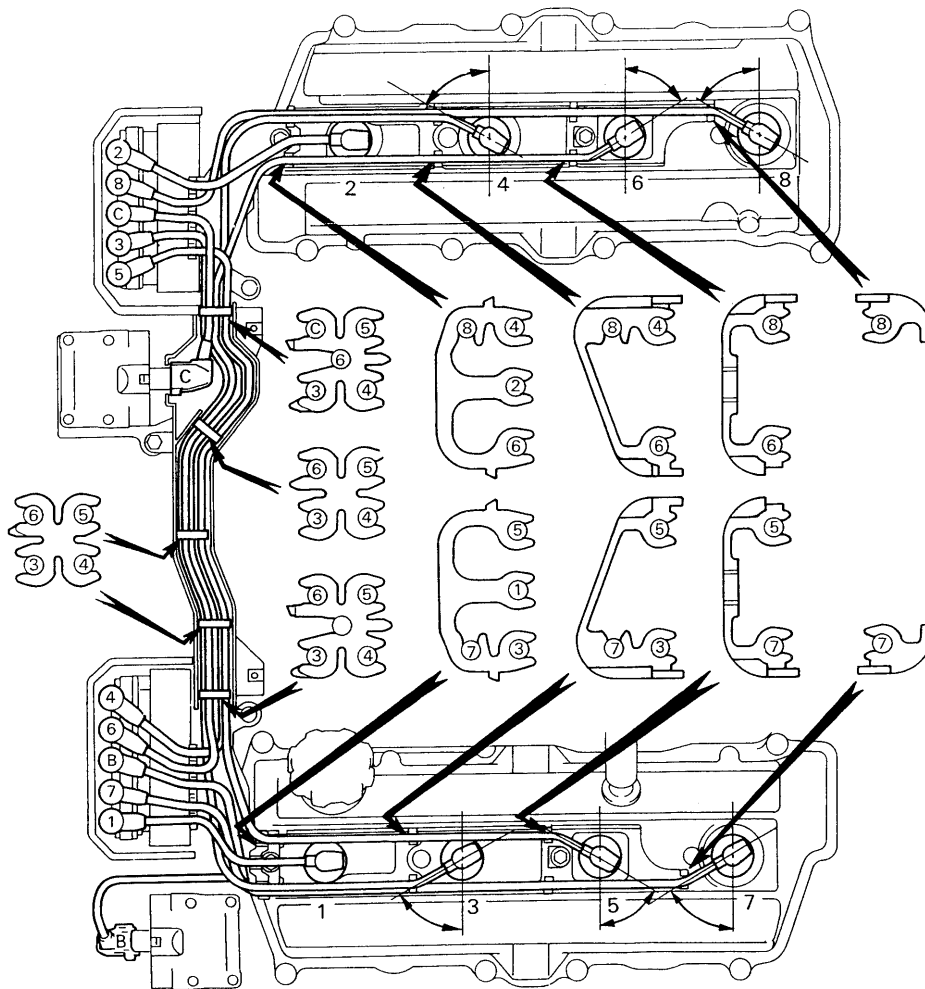

P21298

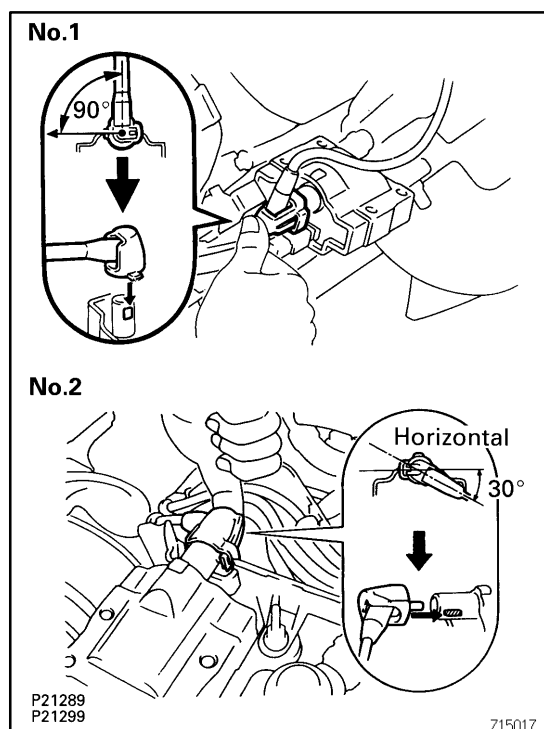

- (c) Connect the high-tension cords to the ignition coils.
- Set the angle of the grommet as shown in the illustration.
 - Align the spline of the ignition coil with the spline of the holder.
 - Install the grommet and holder to the ignition coil until the claw of the holder locks securely.

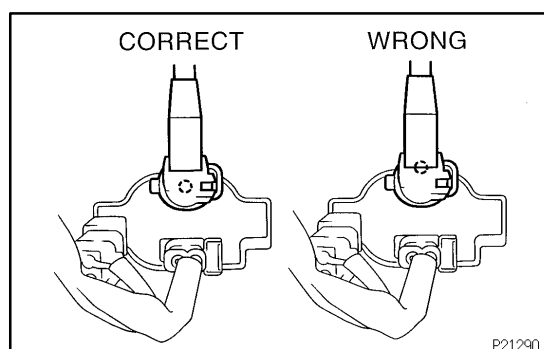
**NOTICE:**

Check that holder is correctly installed to the grommet and ignition coil as shown in the illustration.

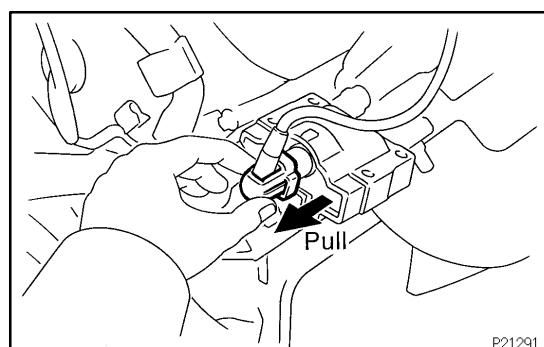

- Check that the lock claw of the holder is engaged by lightly pulling the holder.
- 5. INSTALL NO.3 TIMING BELT COVERS**
(See page [EM-26](#))
 - 6. INSTALL BATTERY CLAMP COVER**