

## Temperature Control Switch Circuit

### CIRCUIT DESCRIPTION

Temp. and Automatic  
Control SW

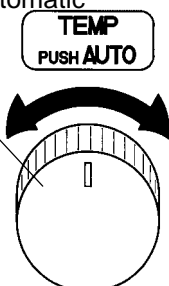

AC2907

By turning the temp. control switch, the set temperature of the A/C can be adjusted in steps of 1°F (USA) or 0.5°C (Canada). Turning the switch fully will set the A/C to MAX. COLD or MAX. HOT.

The ECU calculates the set temperature from the combination of Hi (5V) or Low (0V) terminals SET 1 ~ 5 of the temp. control SW and displays the set temperature on the LCD display.

If a malfunction occurs in the temp. control SW circuit, malfunctions such as not being able to set the desired temperature occur.

### WIRING DIAGRAM

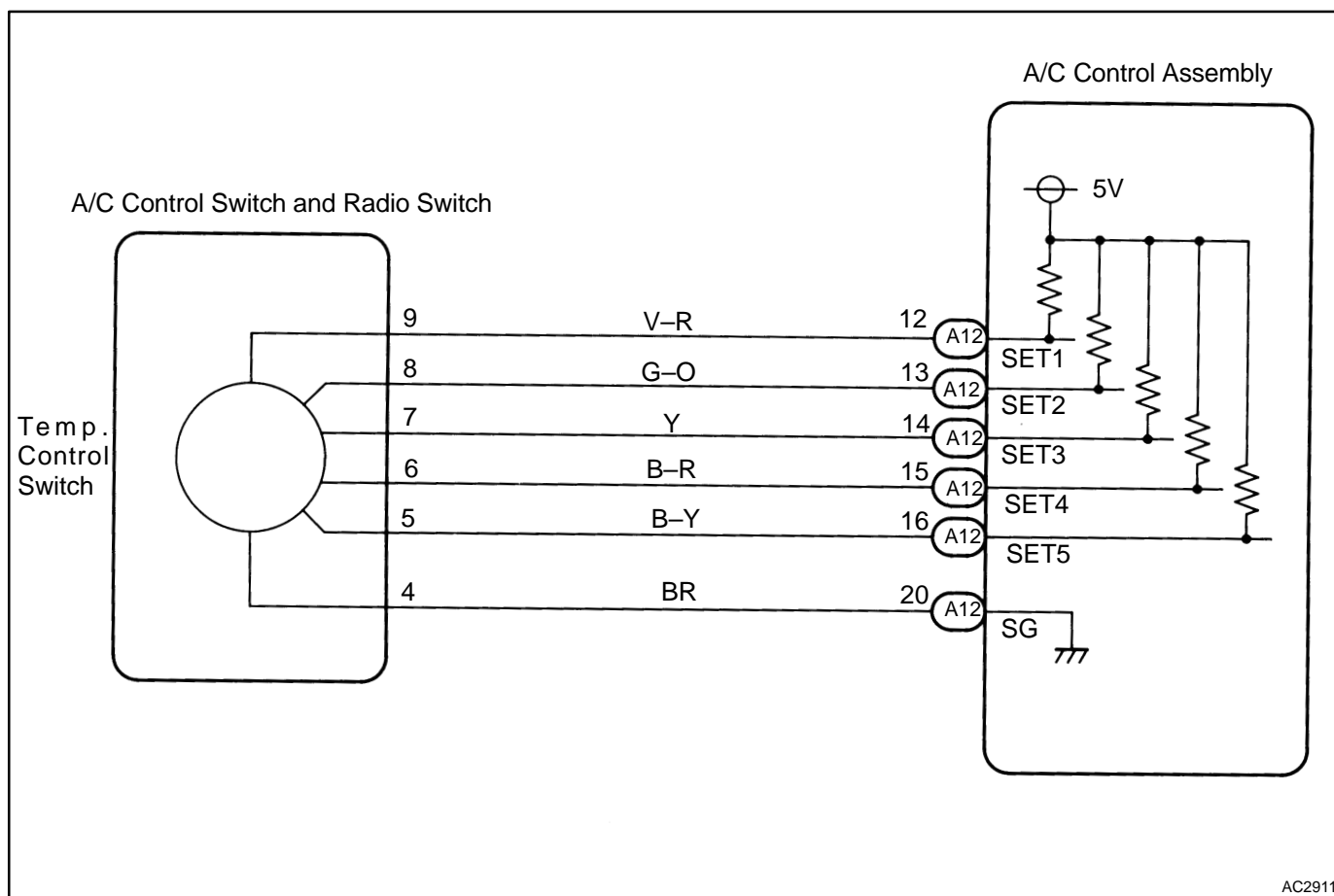

# INSPECTION PROCEDURE

1	Check voltage between terminals SET 1 ~ 5 and SG of A/C control assembly.
---	---

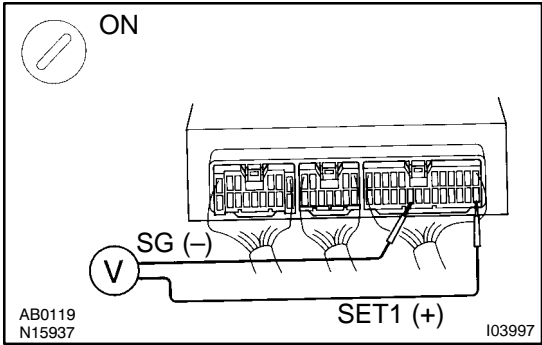

## PREPARATION:

- (a) Remove A/C control assembly with connectors still connected. (See page AC-72)
- (b) Turn ignition switch ON.

## CHECK:

Measure voltage between terminals SET 1 ~ 5 and SG of temp. control switch is turned from most left to right position.

OK : for USA spec.

SW Position terminal	Most Left → Most Right
SET1	0 → 5 → 0 → 5 → 0 → 5 → 0 → 5 → 0 → 5 → 0 → 5
SET2	0 → 5 → 0 → 5 → 0 → 5
SET3	0 → 5 → 0
SET4	5 → 0 → 5
SET5	5 → 0

UNIT [V]

OK : for Canada spec.

SW Position terminal	Most Left → Most Right
SET1	0 → 5 → 0 → 5 → 0 → 5 → 0 → 5 5 ← 0 ← 5 ← 0 ← 5 ← 0 ← 5 ← 0
SET2	5 → 0 → 5 → 0 → 5 → 0 → 5 → 0 → 5
SET3	5 → 0 → 5 → 0 → 5
SET4	5 → 0 → 5
SET5	5 → 0

UNIT [V]

OK

Proceed to next circuit inspection shown on matrix chart (See page DI-821).

NG

Go to step 2.

2

Check temp. control switch.

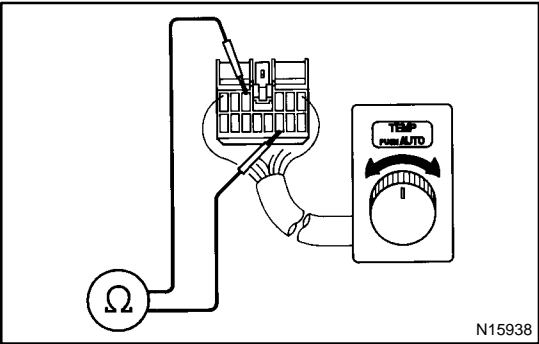

**PREPARATION:**

Disconnect temp. control switch connector.

**CHECK:**

Measure resistance between terminals SET 1 ~ 5 and SG of temp. control switch, when switch is turned from most left to right position.

OK : for USA spec.

SW Position terminal	Most Left	Most Right
SET1	0 → ∞ → 0 → ∞ → 0 → ∞ → 0 → ∞ → 0 → ∞ → 0 → ∞	
SET2	0 → ∞ → 0 → ∞ → 0 → ∞ → 0 → ∞	
SET3	0 → ∞ → 0	
SET4	∞ → 0 → ∞	
SET5	∞ → 0	

UNIT [Ω]

OK : for Canada spec.

SW Position terminal	Most Left	Most Right
SET1	0 → ∞ → 0 → ∞ → 0 → ∞ → 0 → ∞ ∞ ← 0 ← ∞ ← 0 ← ∞ ← 0 ← ∞ ← 0	
SET2	∞ → 0 → ∞ → 0 → ∞ → 0 → ∞ → 0 → ∞	
SET3	∞ → 0 → ∞ → 0	
SET4	∞ → 0 → ∞	
SET5	∞ → 0	

UNIT [Ω]

NG

Replace temp. control switch.

OK

3

Check for open and short in harness and connector between A/C control assembly and temp. control switch (See [IN-29](#)).

NG

Repair or replace harness or connector.

OK

Check and replace A/C control assembly.