

ABS ACTUATOR ON-VEHICLE INSPECTION

HINT:

Using the ABS actuator checker (SST), check the operation of the actuator. If the actuator does not operate, check the operation of sub-wire harness G according to instructions on pages [DI-419](#) and [DI-424](#). If the solenoid and/or pump motor relay are abnormal, replace the relay and inspect the actuator operation again.

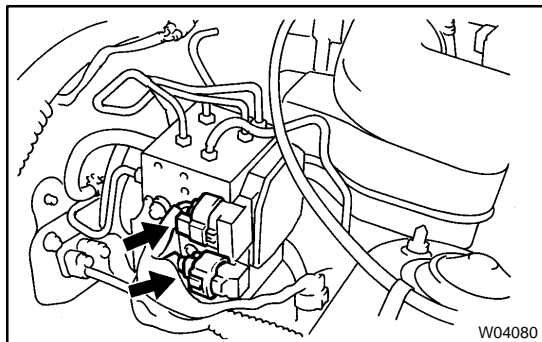

1. INSPECT BATTERY POSITIVE VOLTAGE

Battery positive voltage: 10 – 14 V

2. DISCONNECT CONNECTORS FROM ACTUATOR

Disconnect the 2 connectors from the actuator.

3. CONNECT ACTUATOR CHECKER (SST) TO ACTUATOR

- (a) Connect the actuator checker (SST) to the actuator side wire harnesses via the sub-wire harnesses (SST), as shown.

SST 09990-00150, 09990-00250, 09990-00300, 09990-00360

- (b) Connect the red cable of the checker to the battery positive (+) terminal and the black cable to negative (-) terminal. Connect the block cable of the sub-wire harnesses to the battery negative (-) terminal or body ground.

- (c) Place "SHEET O" (SST) on the actuator checker.

SST 09990-00420

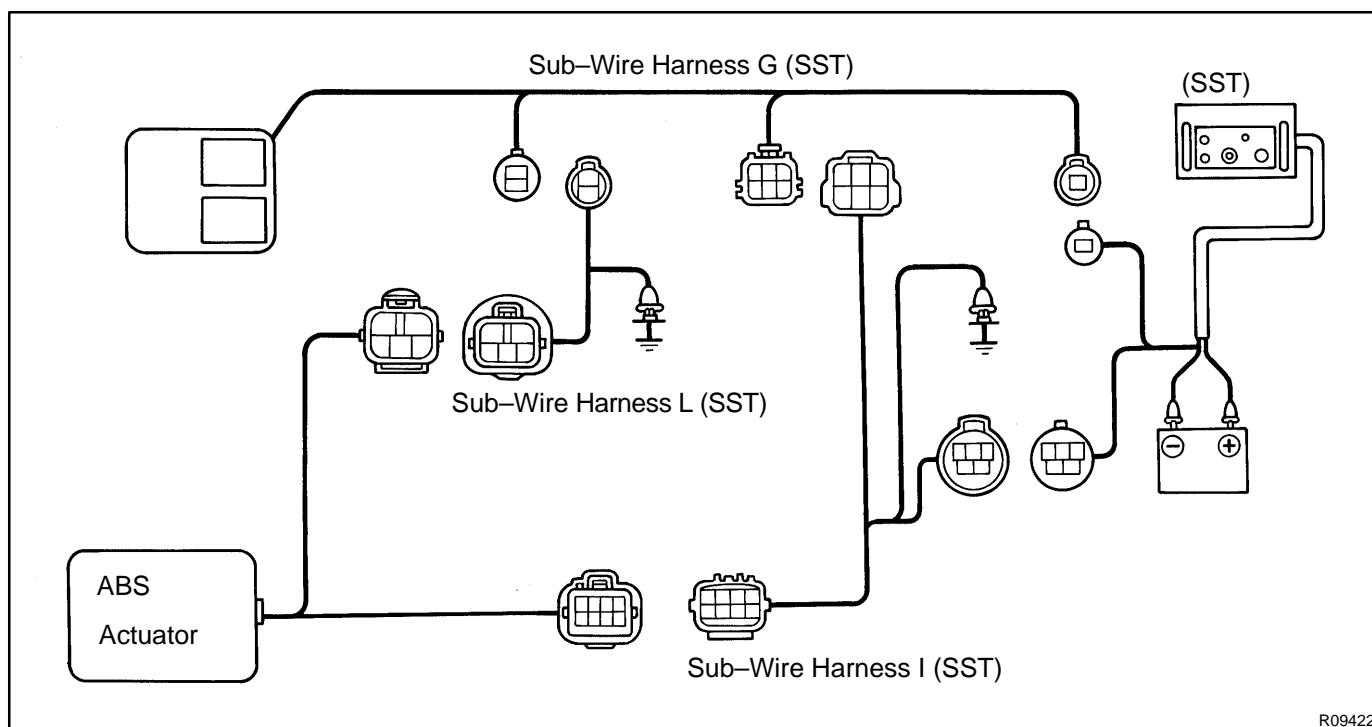

R09422

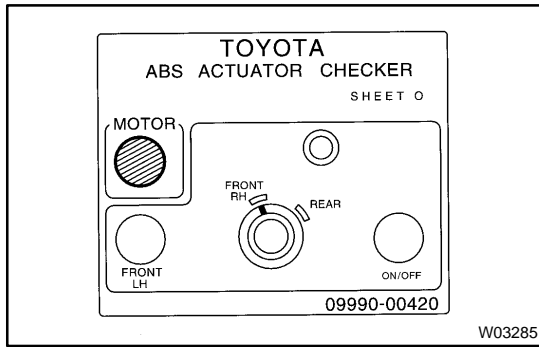

4. INSPECT BRAKE ACTUATOR OPERATION OF FRONT LH WHEEL

- Start the engine, and run it at idle speed.
- Turn the selector switch of the actuator checker to the "FRONT RH" position.
- Push and hold in the MOTOR switch for a few seconds.
- Depress the brake pedal and hold it until step (g) is completed.

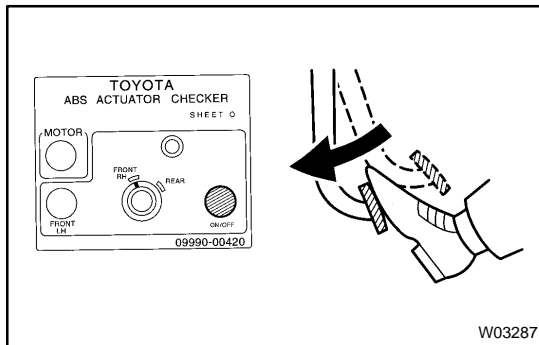

- Push the POWER switch and check that the brake pedal does not go down.

NOTICE:

Do not push the POWER switch for more than 10 seconds.

- Release the switch, and check that the pedal goes down.

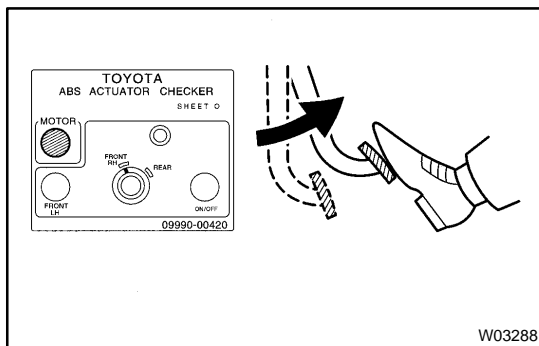

- Push and hold in the MOTOR switch for a few seconds, and check that the pedal returns.
- Release the brake pedal.

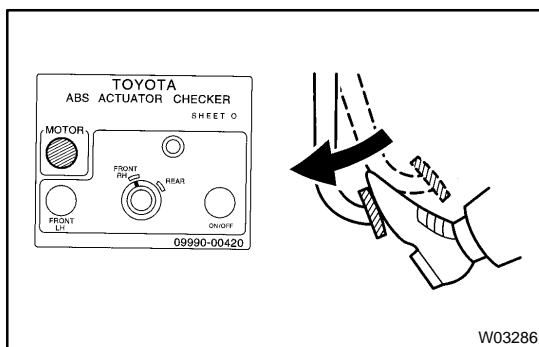

- Push and hold in the MOTOR switch for a few seconds.
- Depress the brake pedal and hold it for about 15 seconds. As you hold the pedal down, push the MOTOR switch for a few seconds. Check that the brake pedal does not pulsate.

- Release the brake pedal.

5. INSPECT FOR OTHER WHEELS

- Turn the selector switch to the "REAR" position, and inspect the "REAR" wheel.
- Repeat (c) to (j) of step 4, checking the actuator operation in the same way.

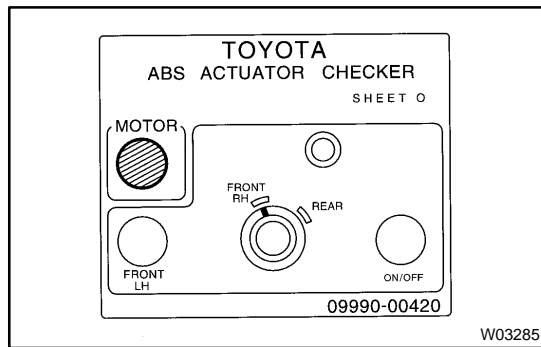

(c) Similarly, inspect "FRONT RH" wheel.

HINT:

When inspecting the "FRONT RH" wheel, push the FRONT LH switch instead of the POWER switch.

This makes it possible to inspect wherever the selector switch position indicates.

6. PUSH MOTOR SWITCH

Push and hold in the MOTOR switch for a few seconds.

7. DISCONNECT ACTUATOR CHECKER (SST) FROM ACTUATOR

(a) Disconnect the actuator checker (SST) and sub-wire harnesses (SST) from the actuator.

SST 09990-00150, 09990-00250, 09990-00300,
09990-00360, 09990-00420

(b) Connect the 2 actuator connectors.

(c) Clear the DTC (See page [DI-408](#)).