

## INSPECTION

### CAUTION:

Replace the seat belt assembly (outer belt, inner belt, bolts, nuts or sill-bar) if it has been used in a severe impact. The entire assembly should be replaced even if damage is not obvious.

#### 1. All Seat Belts:

##### RUNNING TEST (IN SAFE AREA)

- (a) Fasten the front seat belts.
- (b) Drive the car at 10 mph (16 km/h) and make a very hard stop.

Check that the belt locks and cannot be extended at this time.

### HINT:

Conduct this test in a safe area. If the belt does not lock, remove the belt mechanism assembly and conduct the following static check. Also, whenever installing a new belt assembly, verify the proper operation before installation.

#### 2. Driver's Seat Belt (ELR):

##### STATIC TEST

- (a) Verify that the belt locks when pulled out quickly.
- (b) Remove the locking retractor assembly.
- (c) Tilt the retractor slowly.

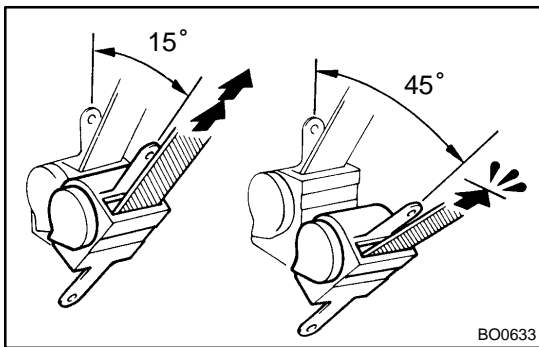

- (d) Verify that the belt can be pulled out at a tilt of 15 degrees or less, and cannot be pulled out at over 45 degrees of tilt. If a problem is found, replace the assembly.

#### 3. Except Driver's Seat Belt (ALR/ELR):

##### STATIC TEST

- (a) Verify that the belt locks when pulled out quickly.
- (b) Remove the locking retractor assembly.

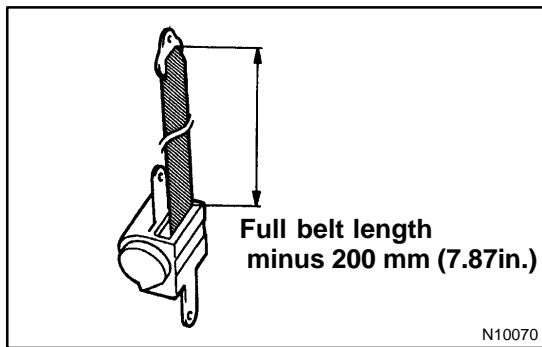

- (c) Pull out the whole belt and measure the length of the whole belt.  
Then retract the belt slightly and pull it out again.
- (d) Verify that the belt cannot be extended further.  
If a problem is found, replace the assembly.
- (e) Retract the whole belt, then pull it out to the full length minus 200 mm (7.87 in.).
- (f) Tilt the retractor slowly.
- (g) Verify that the belt can be pulled out at a tilt of 15 degrees or less, and cannot be pulled out at over 45 degrees of tilt.  
If a problem is found, replace the assembly.