

REMOVAL

1. TILT DOWN AND PULL OUT STEERING WHEEL
2. REMOVE THESE PARTS:
 - (a) Front assist grips
 - (b) Front pillar garnishes
 - (c) Front door scuff plates

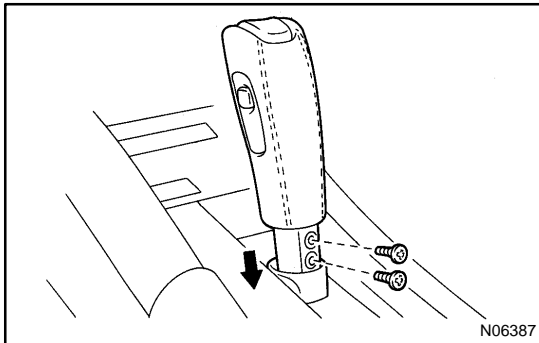

3. REMOVE STEERING WHEEL
(See page [SR-11](#))

NOTICE:

The steering wheel pad should be placed with the pad top surface facing up.

4. REMOVE STEERING COLUMN COVER
5. REMOVE SHIFT LEVER KNOB
 - (a) Slide the shaft collar downward.
 - (b) Remove the 2 screws and knob.

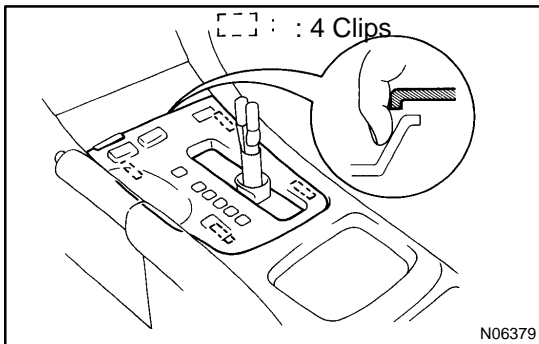

6. REMOVE UPPER CONSOLE PANEL REAR
 - (a) Open the ash tray lid.
 - (b) Lift the console panel toward you as shown.
 - (c) Pass your finger in the shift lever groove and pull the console panel upward away from you.
 - (d) Remove the panel.

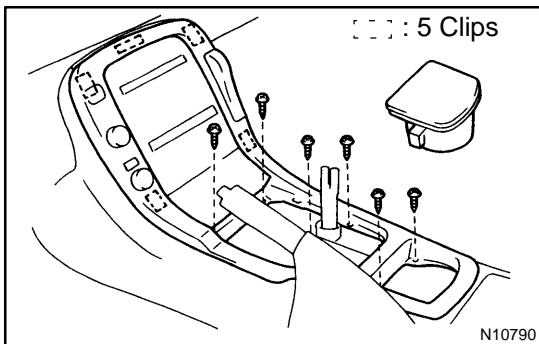

7. REMOVE UPPER CONSOLE PANEL
 - (a) Open the cup holder lid and pull up the holder.
- NOTICE:**
Do not pull the lid.
- (b) Remove the 6 screws and pry out of the upper console panel.
 - (c) Remove cup holder from upper console panel.

8. REMOVE RADIO WITH A/C CONTROL ASSEMBLY

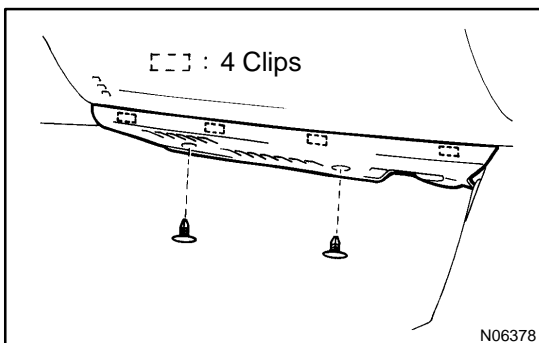

9. REMOVE NO. 2 UNDER COVER
 - (a) Using a clip remover, remove the 2 clips.
 - (b) Pull the cover to remove it.

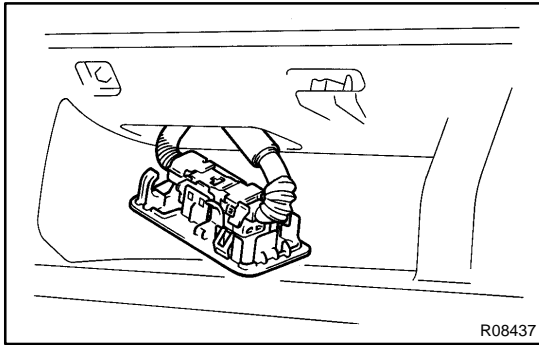

10. DISCONNECT AIRBAG CONNECTOR

- (a) Remove the glove compartment door finish plate inside the instrument panel box.

NOTICE:

When handling the airbag connector, take care not to damage the airbag wire harness.

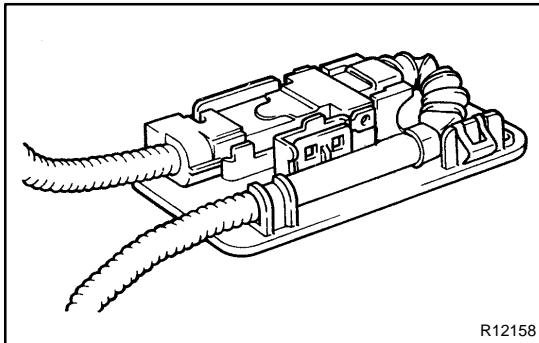

- (b) Pull up the connector.
- (c) Disconnect the airbag connector.

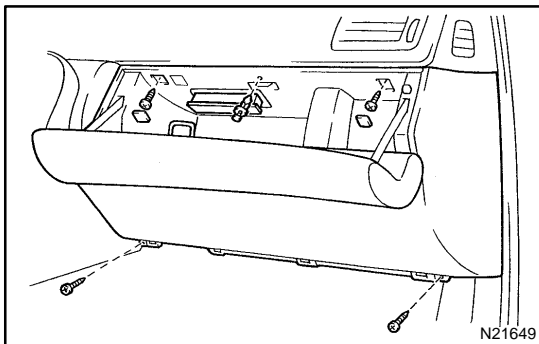

11. REMOVE GLOVE COMPARTMENT ASSEMBLY

- (a) Remove the clip.
- (b) Remove the 2 caps.
- (c) Remove the 4 screws and glove compartment assembly.

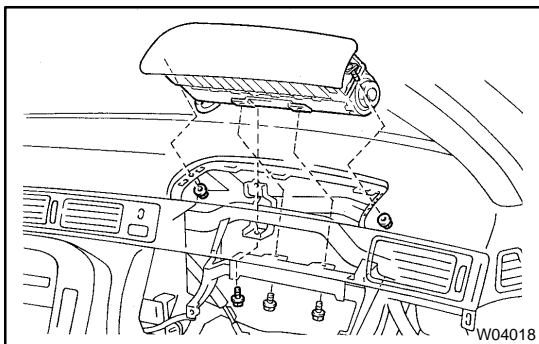

12. REMOVE FRONT PASSENGER AIRBAG ASSEMBLY

- (a) Disconnect the connectors.
- (b) Remove the 3 bolts and 2 nuts.
Torque: 13 N·m (133 kgf·cm, 10 ft·lbf)
- (c) Remove the front passenger airbag assembly.

CAUTION:

- Do not store the front passenger airbag assembly with the airbag deployment direction facing down.
- Never disassemble the front passenger airbag assembly.

NOTICE:

At the time of installation, please refer to the following item.

- Make sure the front passenger airbag assembly is installed to the specified torque.
- If the front passenger airbag assembly has been dropped, or there are cracks, dents or other defects in the case or connector, replace the front passenger airbag assembly with a new one.

- When installing the front passenger airbag assembly, take care that the wiring does not interfere with other parts is not pinched between other parts.

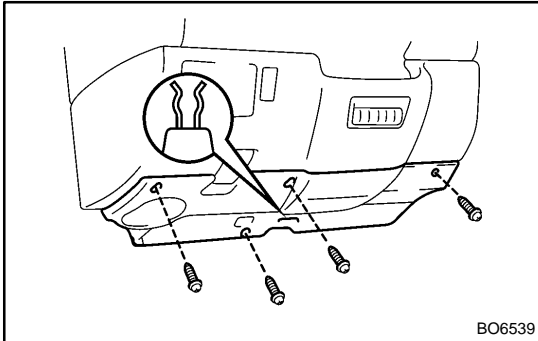

13. REMOVE NO. 1 UNDER COVER

- Remove the 3 screws.
- Using a screwdriver, remove the cover.

HINT:

Tape the screwdriver tip before use.

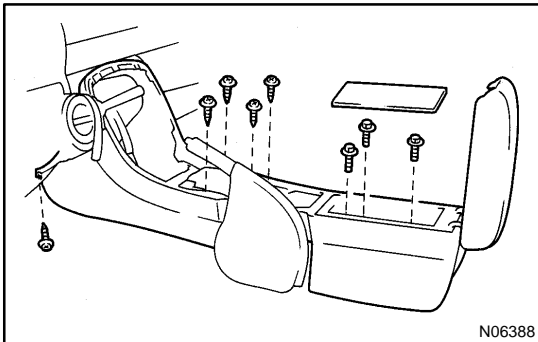

14. REMOVE CONSOLE BOX

Remove the 3 bolts, 5 screws and console box.

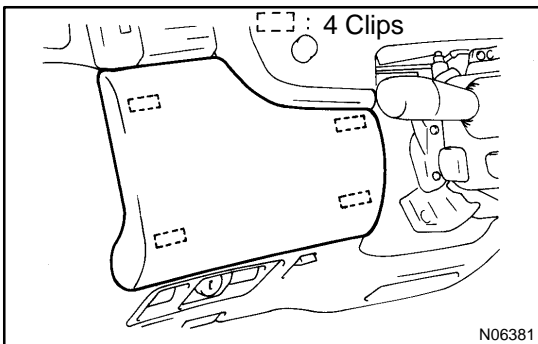

15. REMOVE END PAD

Using a screwdriver, pry out the panel and remove it.

HINT:

Tape the screwdriver tip before use.

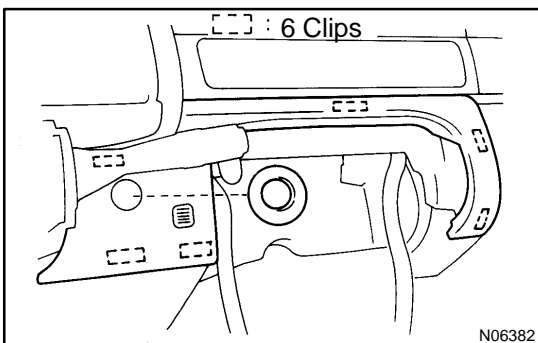

16. REMOVE CENTER PAD

- Remove the key cylinder plate.
- Using a screwdriver, pry out the panel and remove it.

HINT:

Tape the screwdriver tip before use.

17. REMOVE ENGINE HOOD RELEASE LEVER

- Remove the 2 screws and the engine hood release lever.
- Disconnect the release cable from the lever.

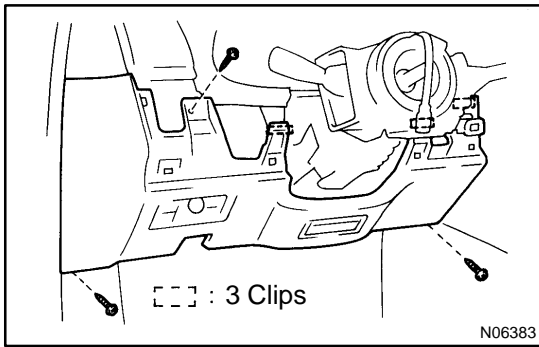
**18. REMOVE NO. 1 LOWER FINISH PANEL**

- (a) Remove the 3 screws.
- (b) Remove the panel, then disconnect the connectors.

19. REMOVE LOWER FINISH PANEL RH

Remove the 4 bolts and panel.

20. REMOVE LOWER FINISH PANEL LH

Remove the 4 bolts and panel.

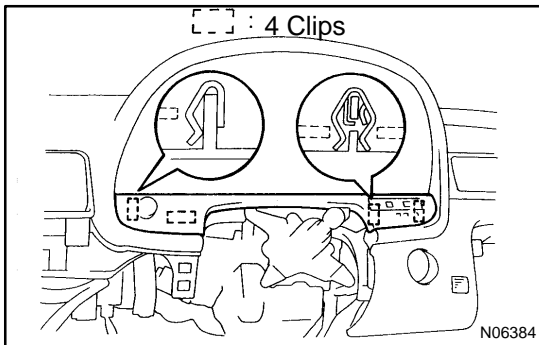
**21. REMOVE THESE PARTS:**

- (a) No. 2 heater to register duct
- (b) No. 4 heater to register duct
- (c) Combination switch
(See page [SR-11](#))
- (d) Cluster finish panel
- (e) Combination meter
- (f) Steering column assembly
(See page [SR-11](#))

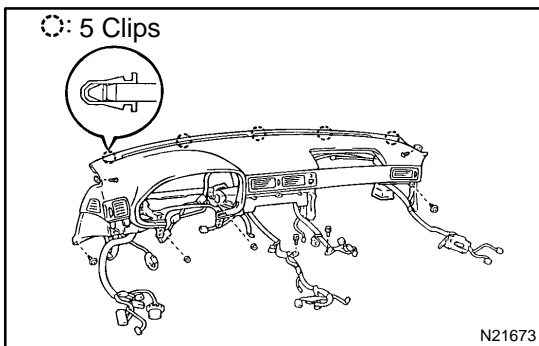
**22. REMOVE INSTRUMENT PANEL**

- (a) Disconnect the connectors.
- (b) Remove the 2 bolts from the wire harness.
- (c) Using a clip remover, remove 2 clips.
- (d) Remove the 2 bolts and 2 nuts from the instrument panel.
- (e) Pull the instrument panel rearward, remove the instrument panel.

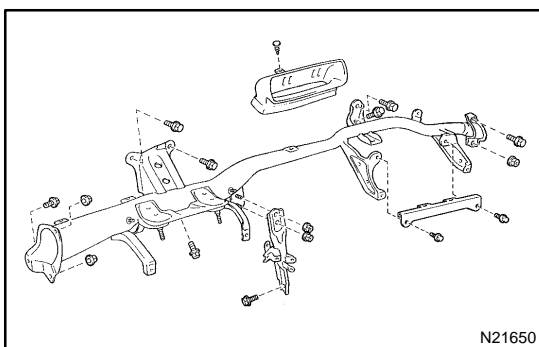
**23. REMOVE INSTRUMENT PANEL REINFORCEMENT**

- (a) Using a clip remover, remove the clip and the No. 3 heater to register duct.
- (b) Remove the bolt, 2 nuts and the instrument panel No. 1 brace.
- (c) Remove the 2 bolts and mounting base.
- (d) Remove the 7 bolts and 3 nuts.
- (e) Remove the instrument panel reinforcement.