

## INSPECTION

### 1. INSPECT ILLUMINATION OPERATION (A/C Control Assembly)

Connect the positive (+) lead from the battery to terminal 31 and negative (-) lead to terminal 43, then check that the illumination lights up.

If operation is not as specified, proceed next inspection.

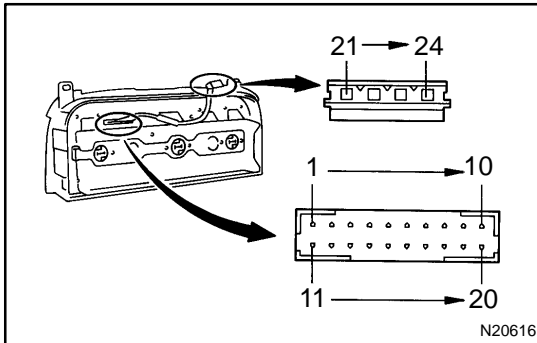

### 2. INSPECT ILLUMINATION OPERATION (A/C Control Panel)

(a) Separate the A/C control panel and amplifier.  
(See page [AC-73](#))

(b) LCD Illumination:

Connect the positive (+) lead from the battery terminal 21 and negative (-) terminal lead to 24 and then check that the illumination lights up.

If operation is not as specified, replace the switch panel.

If operation is as specified, replace the A/C amplifier.

(c) Night Illumination:

Connect the positive (+) lead from the battery terminal 22 and negative (-) lead to terminal 24 and then check that the illumination lights up.

If operation is as specified, replace the A/C amplifier.

If operation is not as specified, proceed next inspection.

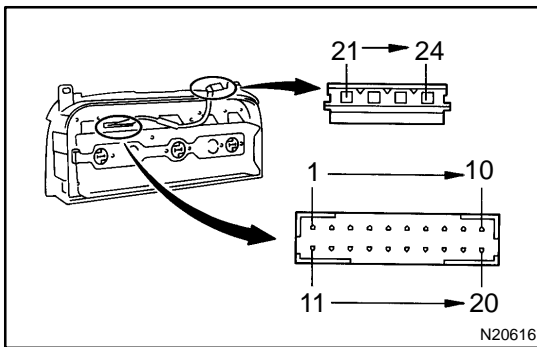

### 3. INSPECT NIGHT LIGHTING BULB CIRCUIT

(a) Remove the bulb.

(b) Check that there is continuity between terminal 24 and 26.

If continuity is not as specified, replace the switch panel.

If continuity is as specified, replace the bulb.

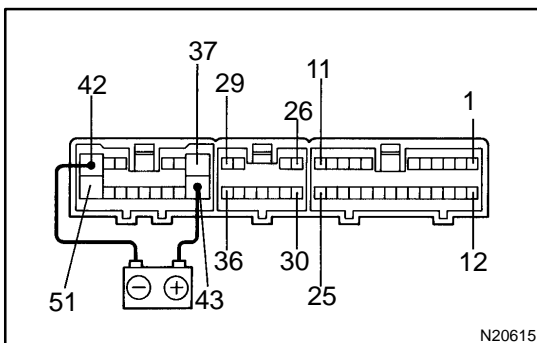

### 4. INSPECT SWITCH OPERATION (A/C Control Assembly)

Connect the positive (+) lead from the battery to terminal 42 and negative (-) lead to terminal 43, then check that the indicator lights up, while switch is pressed.

If operation is not as specified, proceed next inspection.

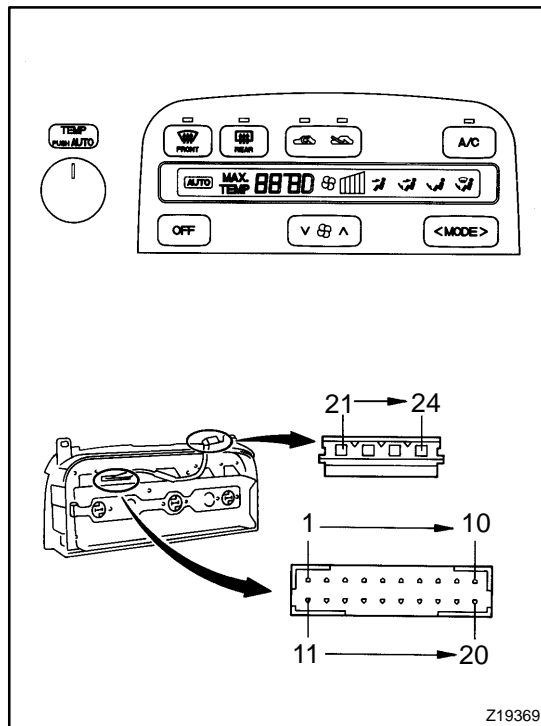

## 5. INSPECT SWITCH OPERATION (A/C Control Panel)

- Separate the amplifier and control panel.  
(See page AC-73)
- Connect two 1.5V dry cell batteries to the terminals in the table to the below, and then check that the indicators light up.

| Indicator | Terminal to connect to dry cell (+) | Terminal to connect to dry cell (-) |
|-----------|-------------------------------------|-------------------------------------|
| A/C       | 10                                  | 18                                  |
| Rr.DEF.   | 20                                  | 18                                  |
| Fr.DEF.   | 20                                  | 8                                   |
| FRESH     | 19                                  | 18                                  |
| RECIRC    | 19                                  | 8                                   |

### NOTICE:

- The indicator lamp uses LEDs so do not mix up the positive (+) and negative (-) terminal of the dry cell batteries.
  - To protect the LEDs, inspect each indicator for no more than 3 seconds each time.
- Check that there is continuity between terminals while the switch is pressed.

| Switch       | Tester connection | Specified condition |
|--------------|-------------------|---------------------|
| A/C          | 13 – 17           | Continuity          |
| MODE (Right) | 13 – 16           | Continuity          |
| MODE (Left)  | 13 – 15           | Continuity          |
| Rr.DEF       | 12 – 17           | Continuity          |
| Fr.DEF       | 12 – 16           | Continuity          |
| FRESH        | 12 – 15           | Continuity          |
| RECIRC       | 12 – 14           | Continuity          |
| OFF          | 11 – 17           | Continuity          |
| FAN +        | 11 – 15           | Continuity          |
| FAN –        | 11 – 16           | Continuity          |

If operations are not as specified, replace the A/C control panel.  
If operations are as specified, check the wire harness or replace the A/C amplifier.

## 6. INSPECT A/C CONTROL ASSEMBLY CIRCUIT (See page DI-818)