

# Upper Arm COMPONENTS

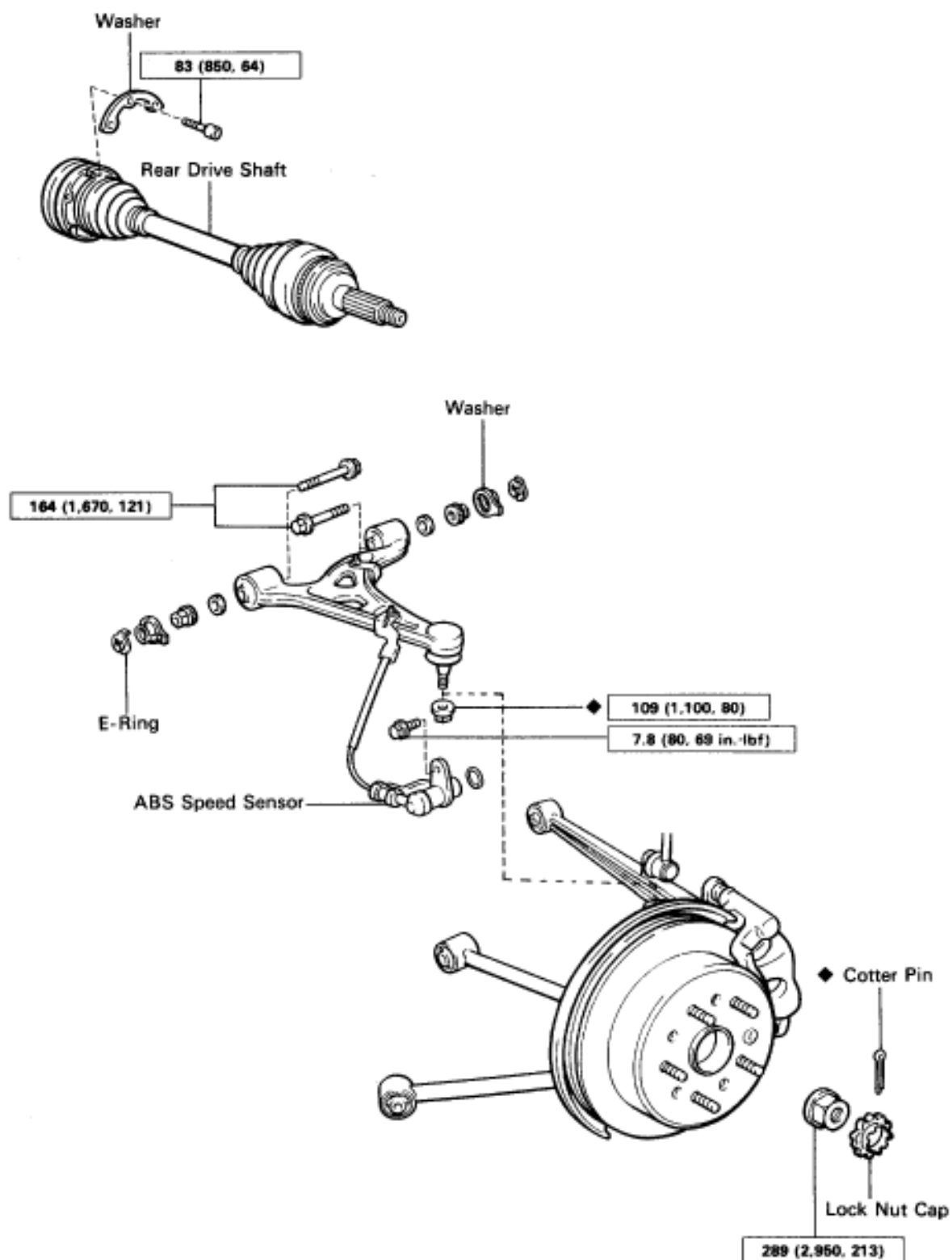

N-m (kgf-cm, ft-lbf) : Specified torque

◆ Non-reusable part

R00616

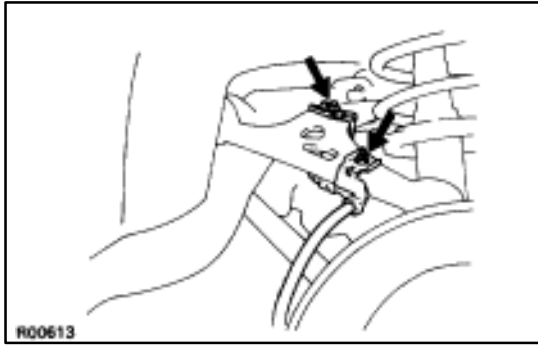

## REMOVAL OF REAR UPPER ARM

1. JACK UP VEHICLE AND REAR WHEEL
2. REMOVE REAR DRIVE SHAFT  
(See page SA-64)
3. REMOVE ABS WIREHARNES CLAMP  
Remove the two bolts and ABS wireharnes clamp.

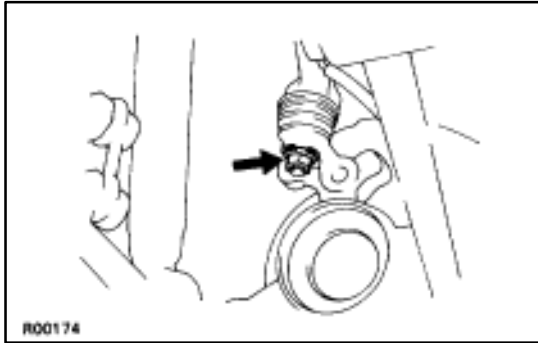

### 4. REMOVE UPPER ARM

- (a) Remove the nut.

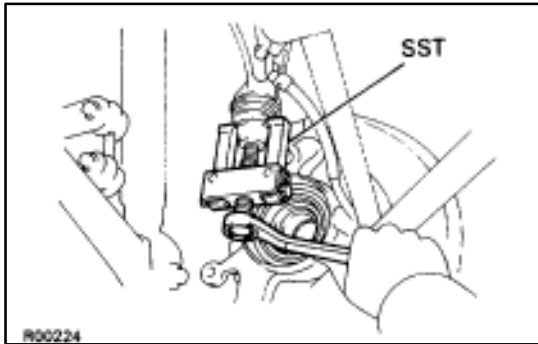

- (b) Using SST, disconnect the upper arm to the axle carrier.  
SST 09628-62011

**NOTICE:** Be careful not to damage the dust cover.

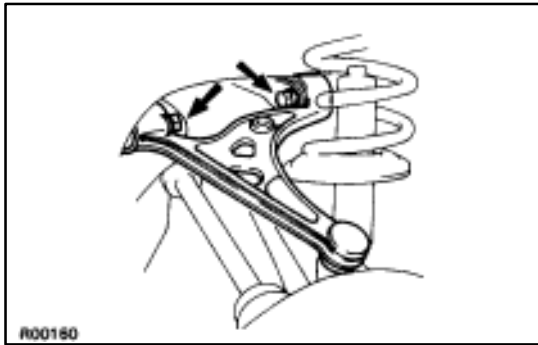

- (c) Remove the bolts and nuts and the upper arm.

## INSPECTION OF UPPER ARM BALL JOINT

### INSPECT BALL JOINT FOR ROTATION CONDITION

- (a) Flip the ball joint stud back and forth 5 times as shown in the figure, before installing the nut.
- (b) Using torque gauge, turn the nut continuously one turn each 2–4 seconds and take the torque reading on the fifth turn.

**Torque (turning): 1.0–3.4 N·m**

**(10–35 kgf·cm, 9–30 in.·lbf)**

If not within specification, replace the upper arm.

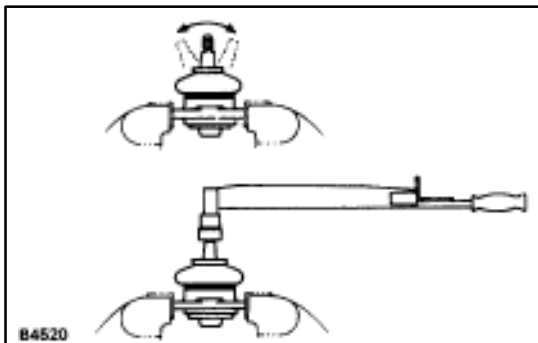

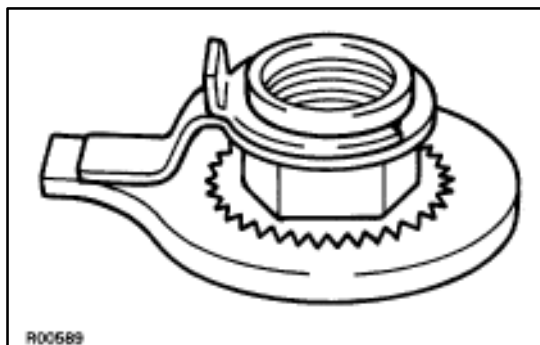

## INSTALLATION OF UPPER ARM

HINT: If replace the nut, assemble the nut and E-ring to the washer with lock protrusion before install.

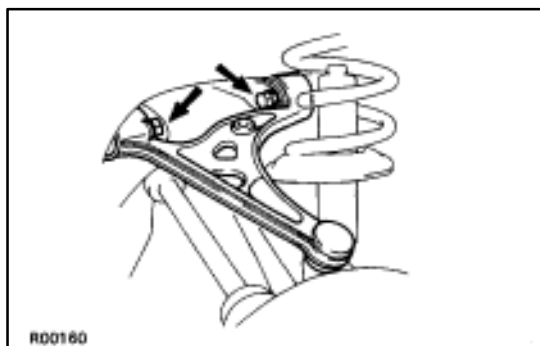

### 1. INSTALL UPPER ARM

(a) Install the upper arm to the body with the bolts and nuts.  
HINT: Install the tip of the nut lock facing down.

**Torque: 164 N·m (1,670 kgf·cm, 121 ft·lbf)**

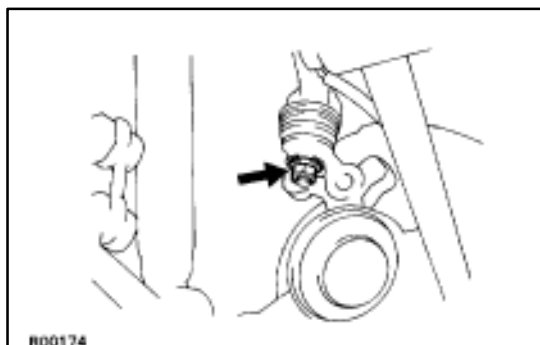

(b) Connect the upper arm to the axle carrier with a new nut.  
**Torque: 109 N·m (1,100 kgf·cm, 80 ft·lbf)**

### 2. INSTALL REAR DRIVE SHAFT

(See page [SA-64](#))

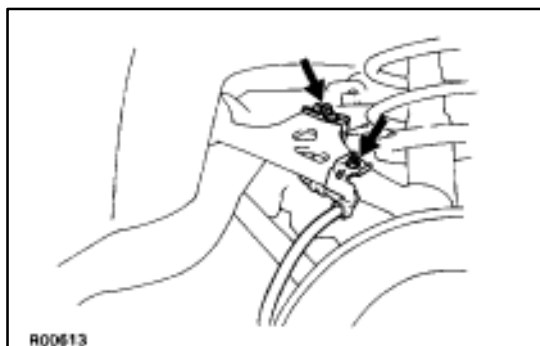

### 3. INSTALL ABS WIREHARNES CLAMP

Connect the ABS wireharness clamp to the upper arm with the two bolts.

### 4. INSTALL REAR WHEEL AND LOWER VEHICLE