

## Stabilizer Bar COMPONENTS

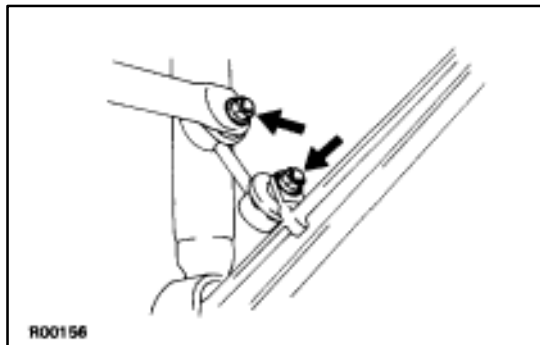

## REMOVAL OF STABILIZER BAR

- 1. DISCONNECT EXHAUST PIPE**
- 2. REMOVE BOTH SIDE STABILIZER BAR LINKS**  
Remove the nuts and the stabilizer bar links.

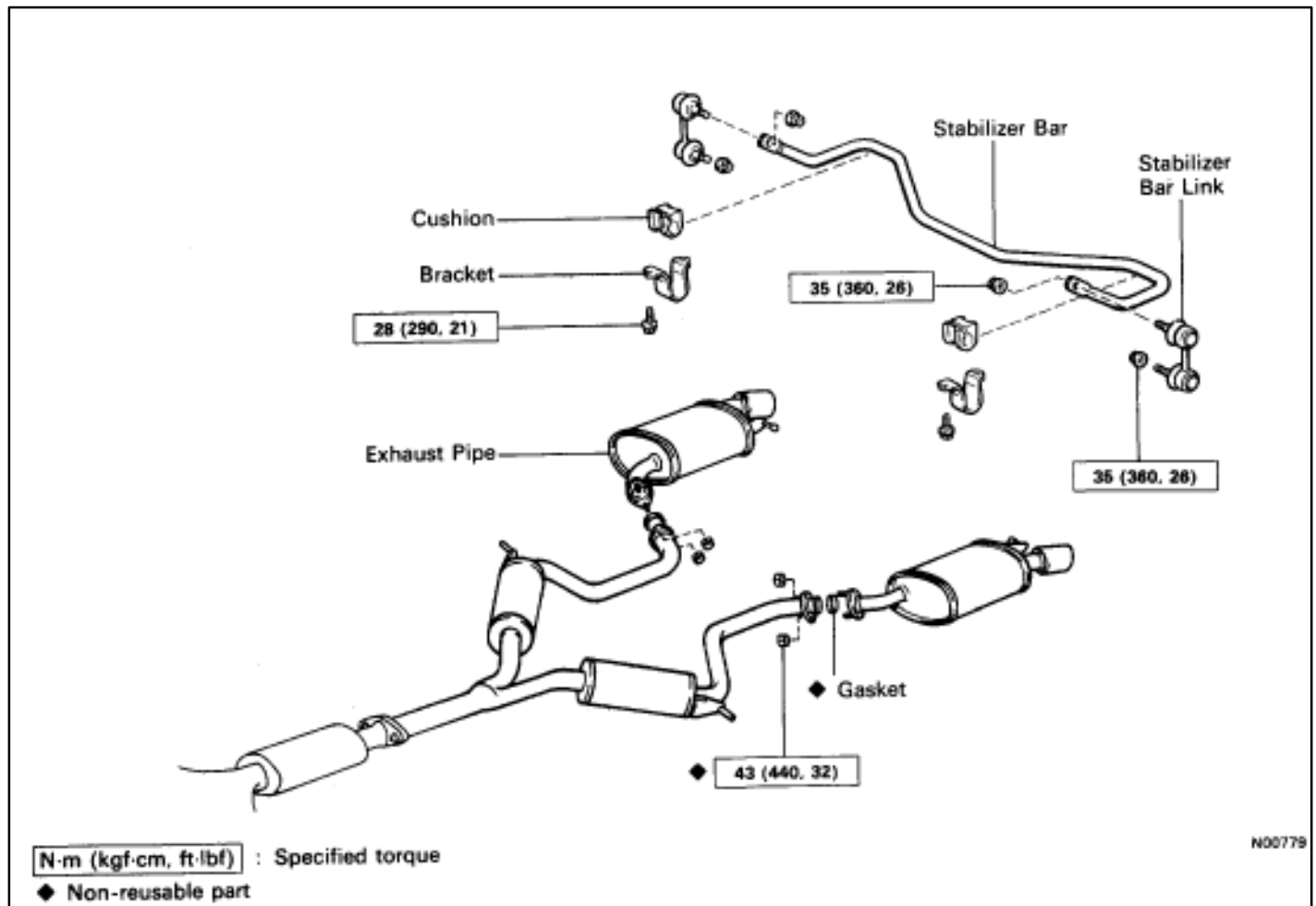
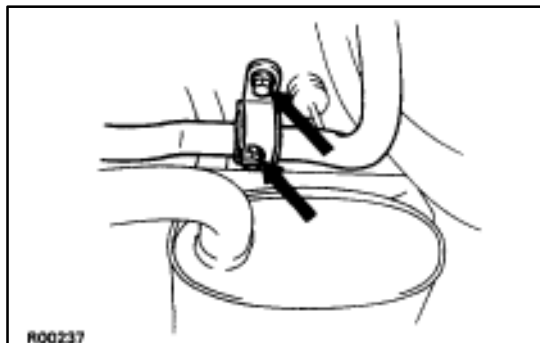

- 3. REMOVE STABILIZER BAR**  
Remove both side the bolts and remove the stabilizer bar with the brackets, cushions and links.

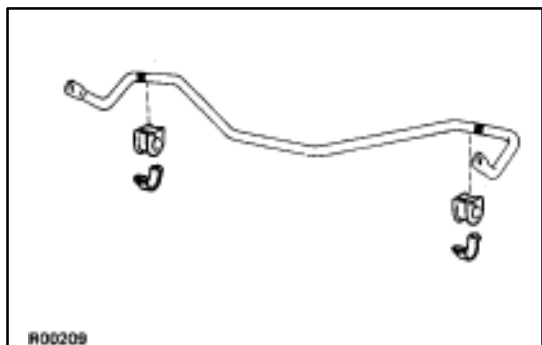

#### 4. REMOVE BOTH SIDE CUSHIONS AND BRACKETS

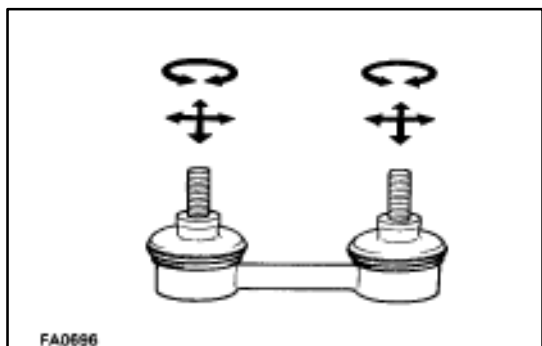

### INSPECTION OF STABILIZER BAR LINK BALL JOINT

#### INSPECT BALL JOINT FOR ROTATION CONDITION

- Flip the ball joint stud back and forth 5 times as shown in the figure, before installing the nut.
- Using a torque gauge, turn the nut continuously one turn each 2–4 seconds and take the torque reading on the fifth turn.

**Torque (turning): 0.3–1.2 N·m**

**(3–12 kgf·cm, 2.6–10.4 in.-lbf)**

If not within specification, replace the stabilizer bar link.

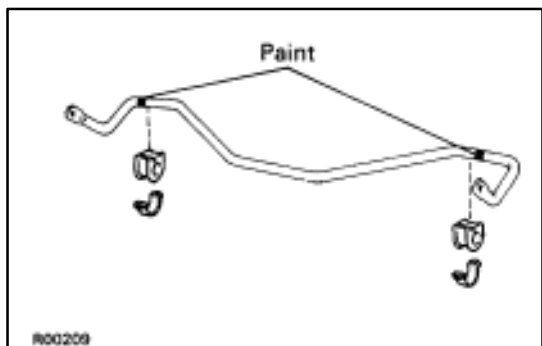

### INSTALLATION OF STABILIZER BAR

#### 1. INSTALL BOTH SIDE CUSHIONS AND BRACKET

- Install the cushion so as to touch the line painted on the stabilizer bar.

**HINT:** Install the cushion to the outside of the line.

- Install the brackets.

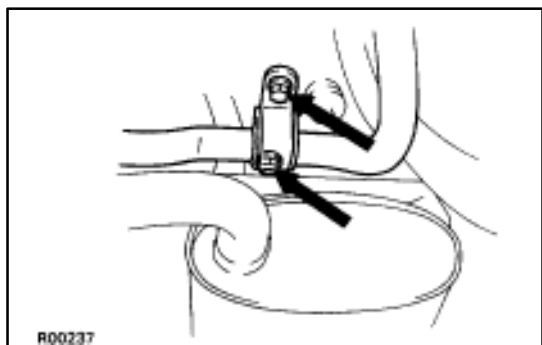

#### 2. INSTALL STABILIZER BAR

Install the stabilizer bar with the brackets, cushions and bolts.

**Torque: 28 N·m (290 kgf·cm, 21 ft-lbf)**

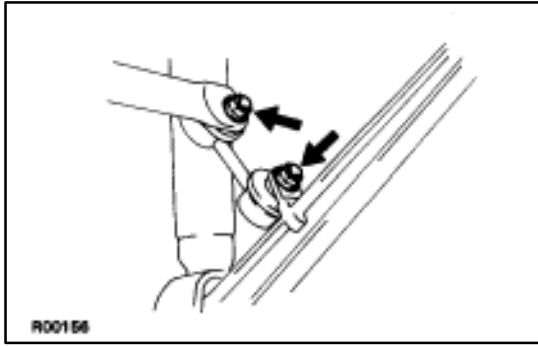
**3. INSTALL BOTH SIDE STABILIZER BAR LINKS**

Install the stabilizer bar links to the stabilizer bar and the No. 2 lower suspension arm with the nuts.

**Torque: 35 N·m (360 kgf·cm, 26 ft·lbf)**

**4. CONNECT EXHAUST PIPE**