

## On-Vehicle Repair COMPONENTS

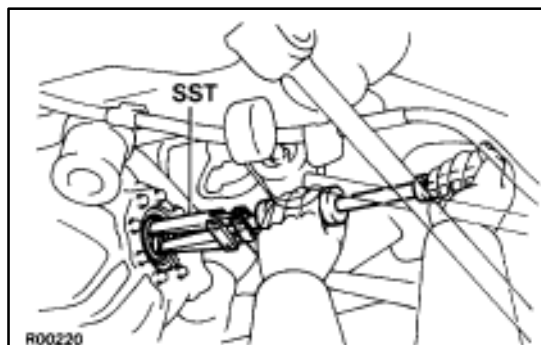
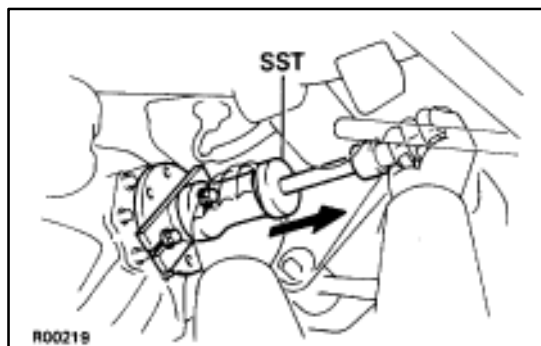
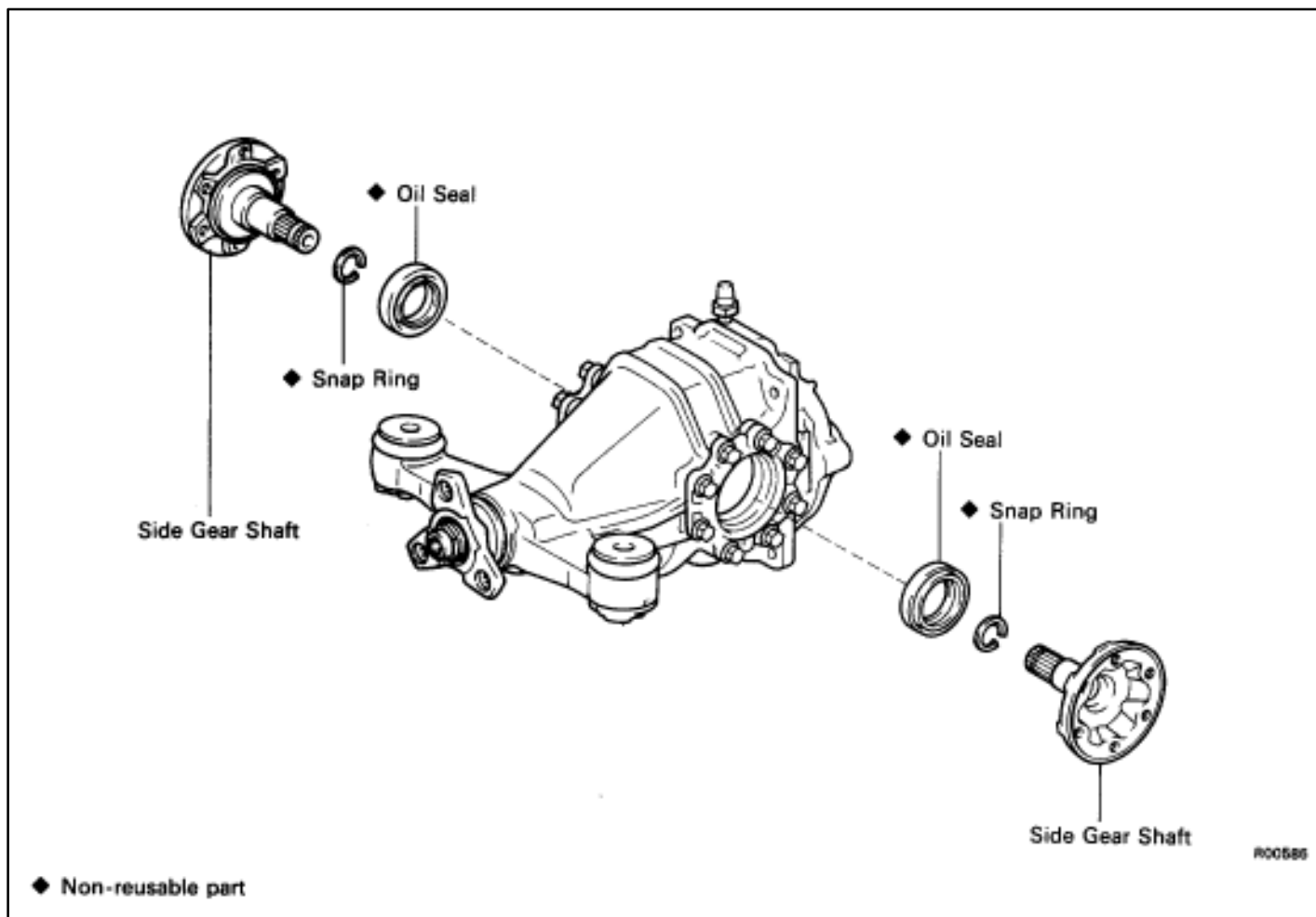
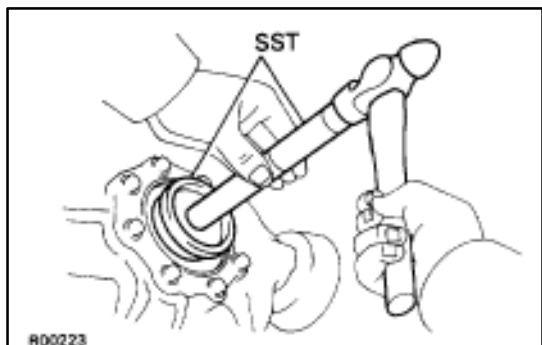

### ON-VEHICLE REPLACEMENT OF SIDE GEAR SHAFT OIL SEAL

1. DRAIN DIFFERENTIAL OIL
2. REMOVE REAR DRIVE SHAFT  
(See page [SA-64](#))
3. REMOVE SIDE GEAR SHAFT
  - (a) Using SST and two bolts, remove the side gear shaft.  
SST 09520-24010
  - (b) Remove the snap ring from the side gear shaft.
4. REMOVE SIDE GEAR SHAFT OIL SEAL  
Using SST, remove the oil seal.  
SST 09308-00010

**5. INSTALL SIDE GEAR SHAFT OIL SEAL**

- (a) Using SST and a hammer, drive in a new oil seal.  
SST 09608-32010, 09608-35014 (09608-06020)
- (b) Apply MP grease to the oil seal lip.

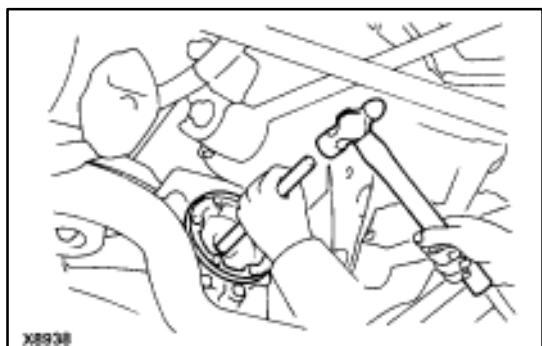
**6. INSTALL SIDE GEAR SHAFT**

- (a) Install a new snap ring to the side gear shaft.
- (b) Using a hammer and brass bar, tap in the side gear shaft to the differential.

**NOTICE:** Be careful not damage the side gear shaft and oil seal.

**7. CHECK INSTALLATION OF SIDE GEAR SHAFT**

- (a) Check that there is 2–3 mm (0.08–0.12 in.) of play in axial direction.
- (b) Check that the side gear shaft will not come out by trying to pull it completely out by hand.

**8. INSTALL REAR DRIVE SHAFT**

(See page [SA-64](#))

**9. CHECK DIFFERENTIAL OIL**

Fill with hypoid gear oil if necessary.

**Oil grade:** API GL-5

**Viscosity:** Above–18°C (0°F) SAE 90

Below–18°C (0°F) SAE 80W-90 or 80W

**Capacity:** 1.35 liters (1.43 US qts, 1.19 Imp. qts)

