

Fuel Tank and Lines COMPONENTS

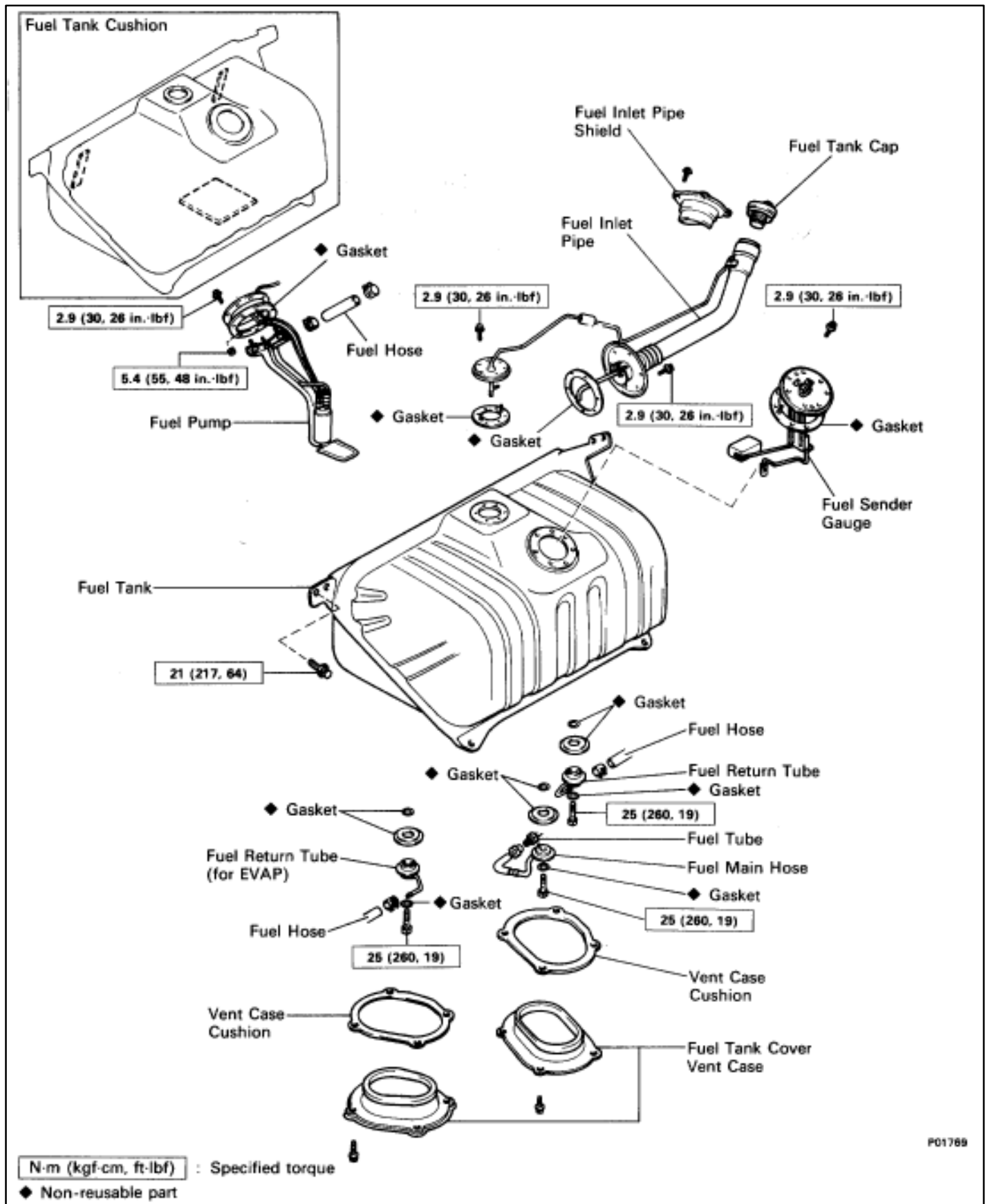

PRECAUTIONS

1. Always use new gaskets when replacing the fuel tank or component part.
2. Apply the proper torque to all parts tightened.

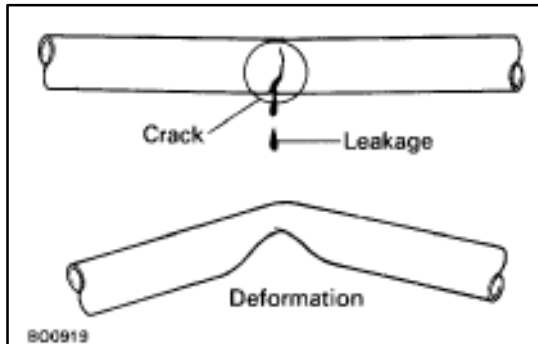

INSPECTION OF FUEL LINES AND CONNECTIONS

- (a) Inspect the fuel lines and connections for cracks, leakage or deformation.
- (b) Inspect the fuel tank vapor vent system hoses and connections for looseness, kinks or damage.
- (c) Inspect the fuel tank for deformation, cracks, fuel leakage or tank band looseness.
- (d) Check the filter neck for damage or fuel leakage.
- (e) Hose and tube connections are as shown in the illustration.

If a problem is found, repair or replace the parts as necessary.

