EMISSION CONTROL SYSTEM

NOTE: The specification descriptions "**USA Spec.**" and "**Exc. USA Spec.**" used in this section indicate the following specifications.

USA Spec.: USA (50 States) Specifications

Exc. USA Spec.: USA (except California) and Canadian Specifications.

DESCRIPTION

The emission control systems are installed to reduce the amount of HC, CO, and NO_x emitted from the engine, and to also prevent the release of evaporated fuel from the gasoline tank and prevent atmospheric release of blow-by gas.

The system consists of the PCV, EVAP, EGR and TWC.

The function of each system is shown in the following table.

System	Abbreviation	Purpose
Positive crankcase ventilation	PCV	Reduces blow-by gas (HC)
Fuel evaporative emission control	EVAP	Reduces evaporative HC
Exhaust gas recirculation	EGR	Reduces NO _x
Three-way catalyst	TWC	Reduces HC, CO, and NO _x
Electronic fuel injection*	EFI	Regulates all engine conditions for reduction of exhaust emissions.

Remarks: * For inspection and repair of the EFI system, refer to EFI section.

COMPONENTS LAYOUT

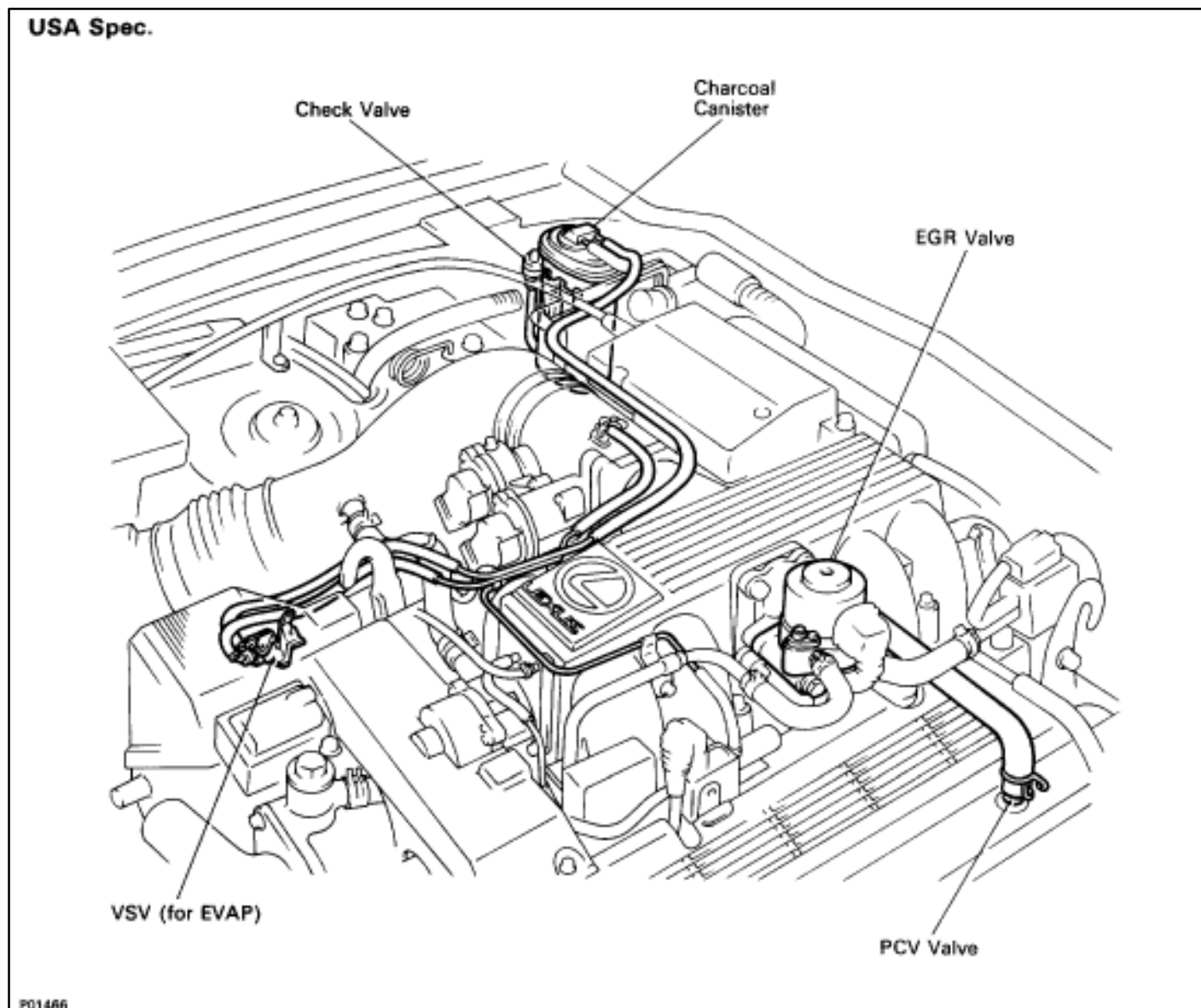

COMPONENTS LAYOUT (Cont'd)

Exc. USA Spec.

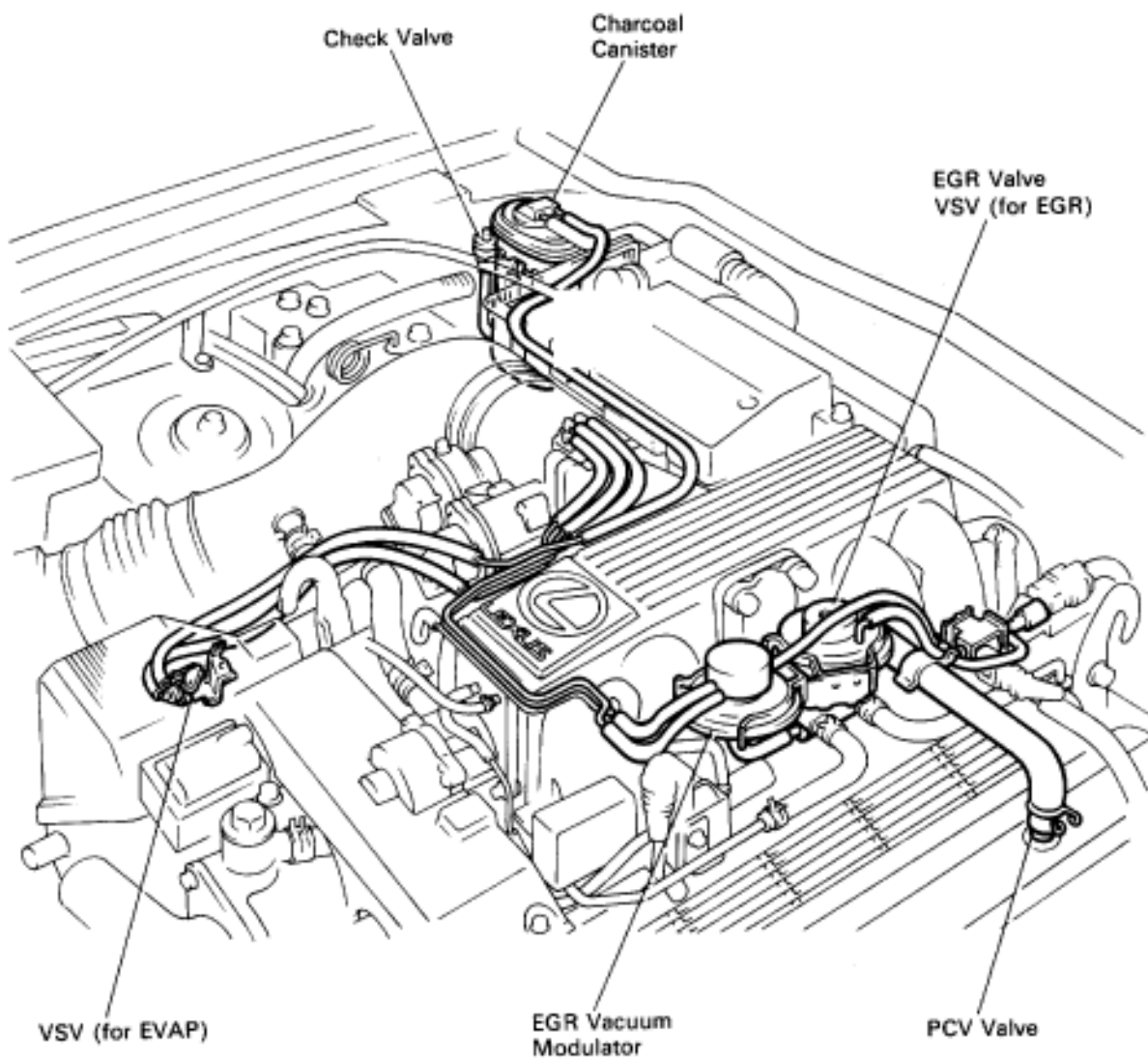

SCHEMATIC DRAWING

USA Spec.

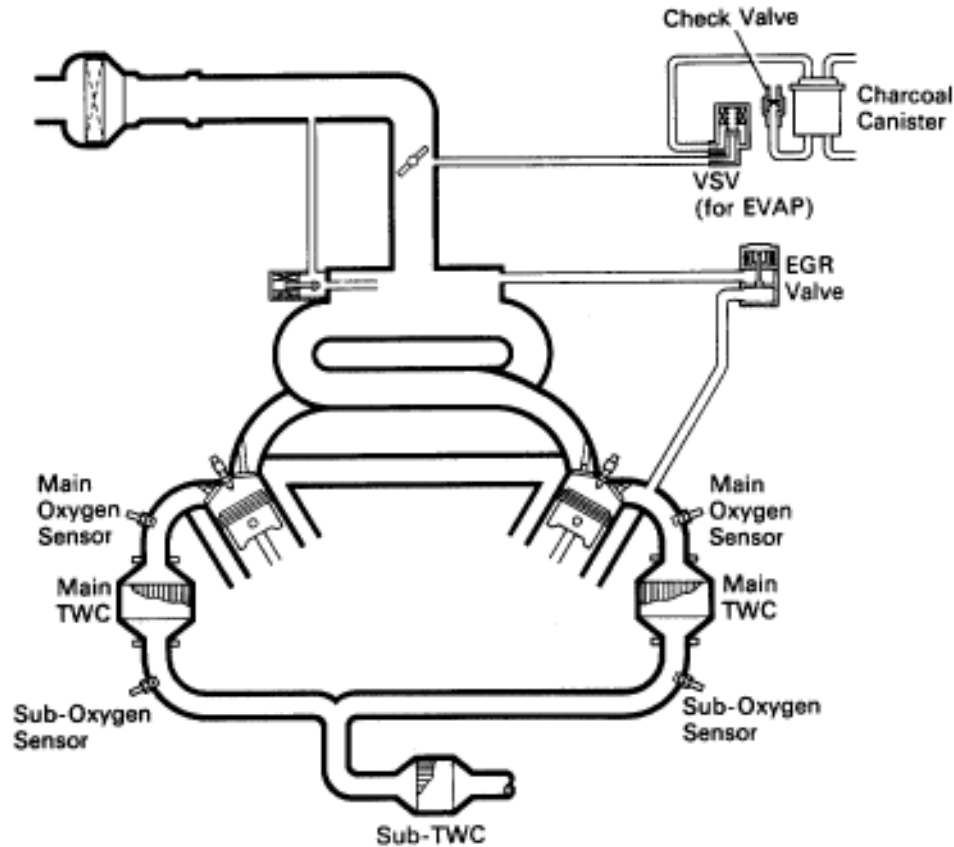

N00617

Exc. USA Spec.

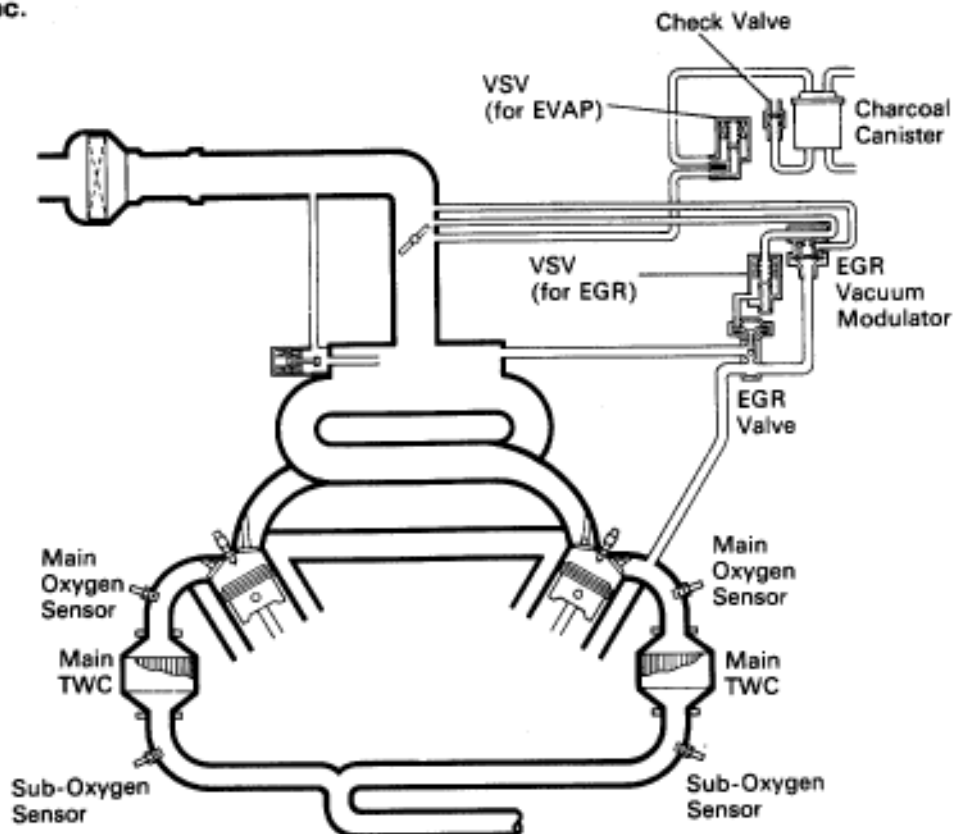

N00618