

# TRAC ACTUATOR REMOVAL AND INSTALLATION OF TRAC ACTUATOR

Remove and install the parts as shown.

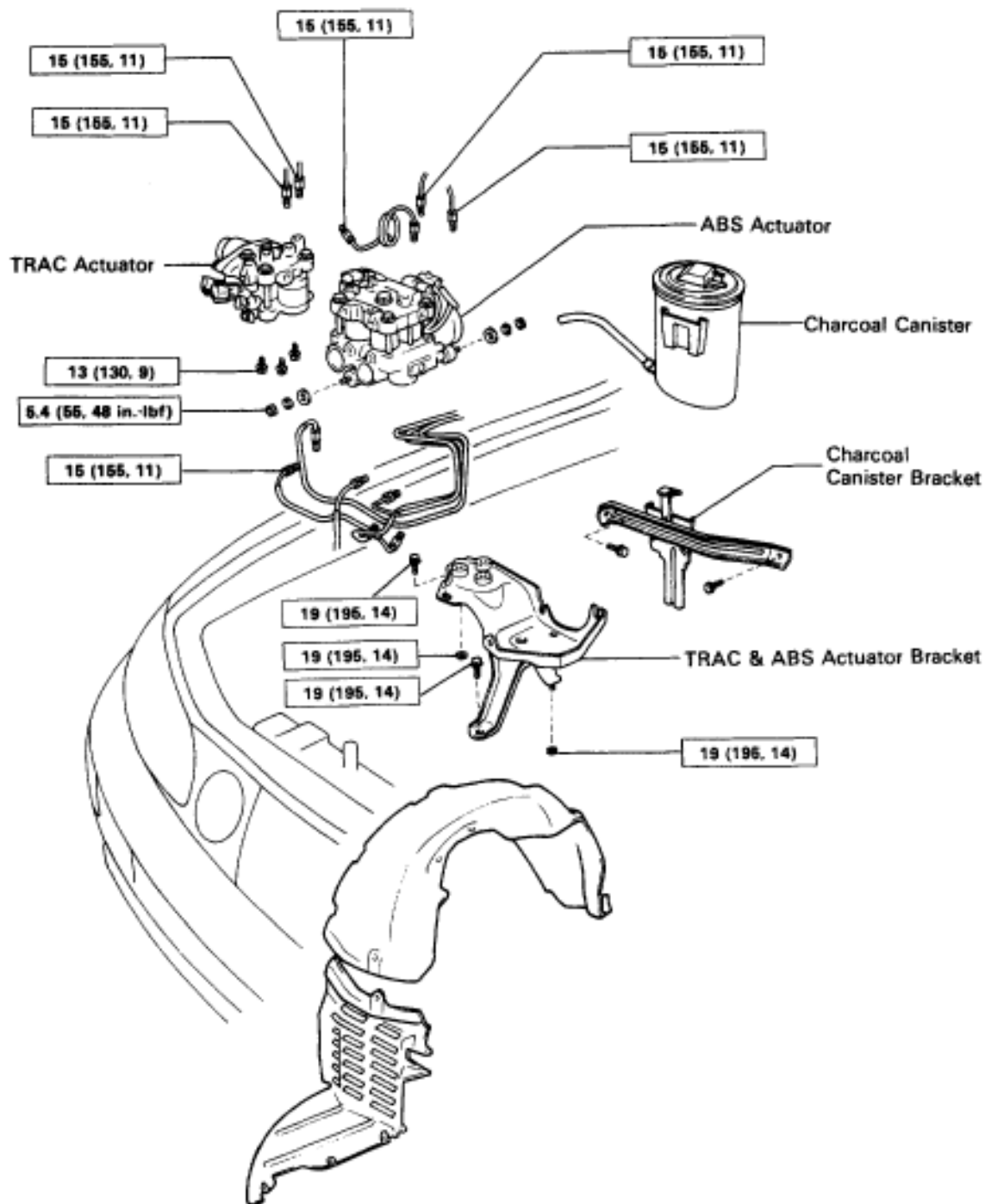

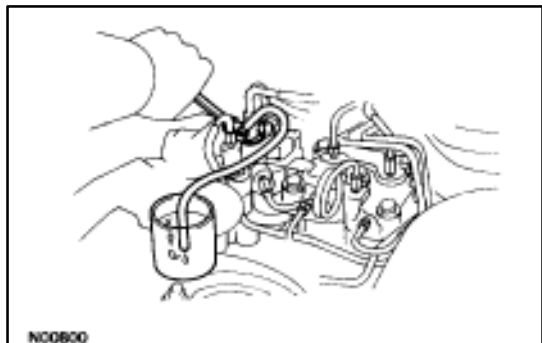

## (MAIN POINTS OF REMOVAL AND INSTALLATION)

### 1. DRAIN OUT HIGH PRESSURE FLUID

- Connect a vinyl tube to the TRAC actuator bleeder plug, then loosen the bleeder plug.
- When the fluid has flowed out, tighten the bleeder plug.

**CAUTION:** Since the fluid is under high pressure, it could spray out with great force, so be careful.

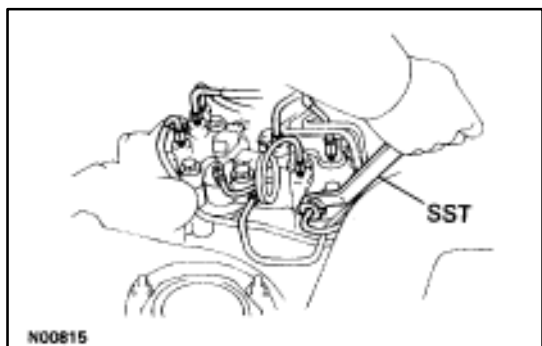

### 2. DISCONNECT AND CONNECT BRAKE TUBE

Using SST, disconnect and connect the brake tube from/ to the TRAC actuator and ABS actuator.

SST 09751-36011

**Torque:** 15 N·m (155 kgf·cm, 11 ft·lbf)

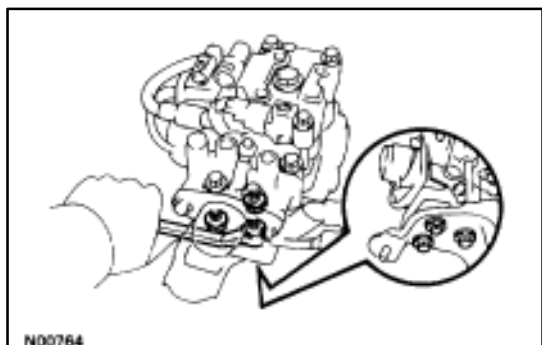

### 3. REMOVE AND INSTALL TRAC ACTUATOR

Loosen and tighten the three bolts.

**Torque:** 13 N·m (130 kgf·cm, 9 ft·lbf)

**HINT:** When loosening or tightening TRAC actuator installation bolts, lift the actuator bracket up slightly from the body.

### 4. BLEED BRAKE SYSTEM AND TRAC SYSTEM (See pages [BR-6](#) and 8)