

BODY

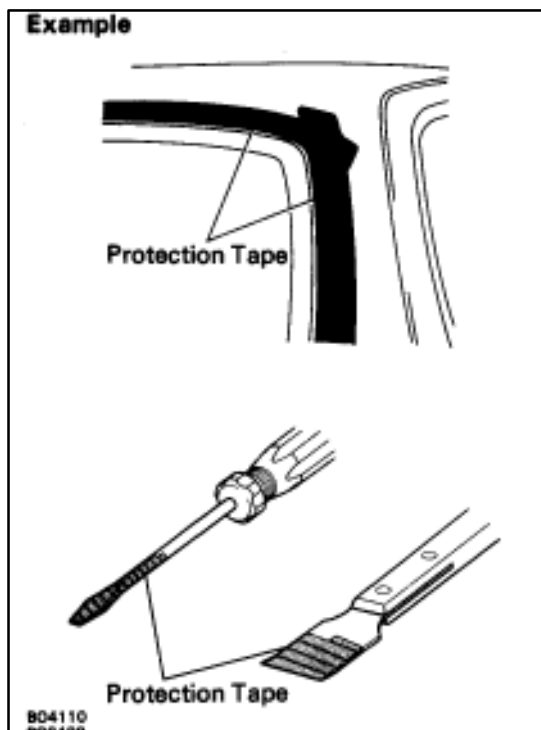

GENERAL INFORMATION

HANDLING PRECAUTIONS

Taping

When it is possible that the body or parts may be scratched during the operation, apply protection tape before starting work.

Example:

1. Before starting work, apply protection tape to body surfaces around parts to be removed and installed.
2. Before prying parts loose with a screwdriver or scraper etc., apply protection tape to the tip of the tool to avoid scratching parts or painted surfaces of the body.

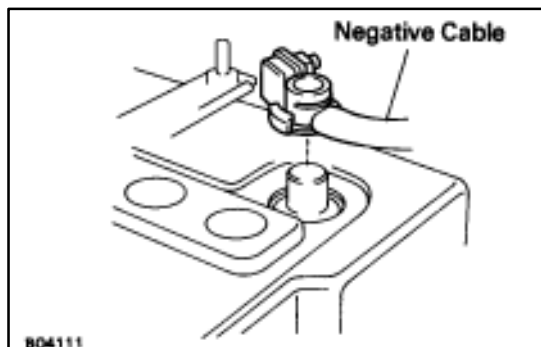

Battery

In order to prevent a short circuit while doing work on the electrical circuit such as disconnecting a connector, first turn off the ignition switch and disconnect the negative cable from the battery terminal before starting work.

HINT: When battery voltage is required for operation of a functioning part, connect the cable to the battery when needed, and promptly disconnect it when no longer necessary.

CAUTION:

- Work must be started after approx. 20 seconds or longer from the time the ignition switch is turned to the "LOCK" position and the negative (-) terminal cable is disconnected from the battery.
- To avoid erasing the memory of each memory system, never use a back-up power supply from outside the vehicle.

Fitting Adjustments

When removing and installing body panels which have a pre-load value, after the installation refer to the page containing the installation adjustment methods, and make adjustments according to the required specifications.

HINT: When making adjustments, do not completely loosen the bolts and nuts of the part being adjusted. Tighten them appropriately, and move the panels by hand to align them.

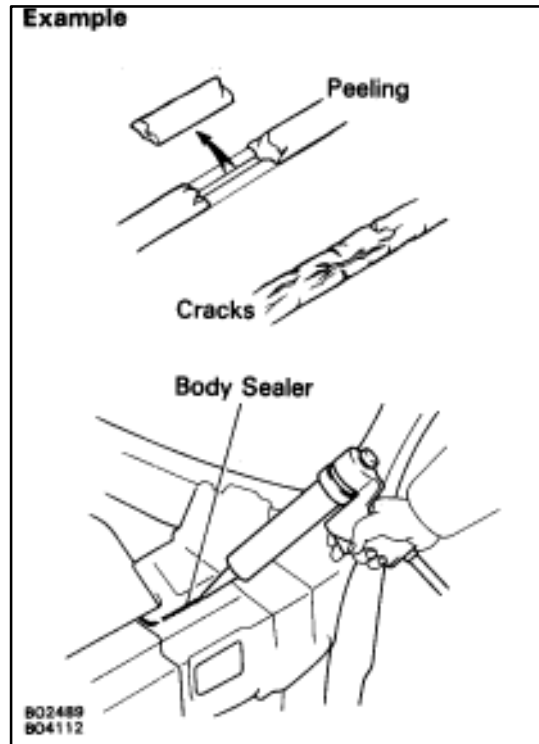

ANTI-RUST TREATMENT

Anti-rust treatment used on the vehicle body includes body sealer, undercoat, rust inhibitor and paint.

HINT: Refer to the Body Collision Damage Repair Manual for details of which parts have received anti-rust treatment.

Body Sealer

If the body sealer is damaged (peeling, cracks, etc.) during the operation, replace it with new body sealer.

HINT: If body sealer gets on other parts, promptly wipe it off with a clean cloth dipped in a grease, wax and silicone remover.

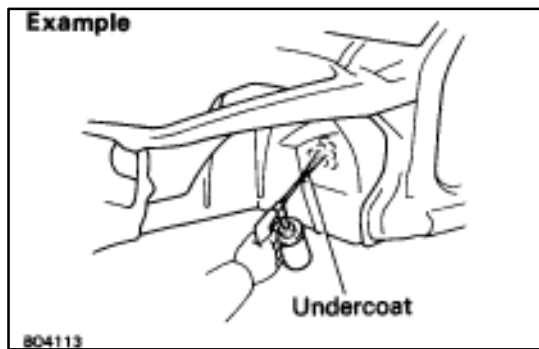

Undercoat

If the undercoat is damaged during the operation apply new undercoat.

HINT:

- Cover the surrounding area with masking paper to avoid applying undercoat where it is not needed.
- Do not apply undercoat to high temperature parts such as the tailpipe, or to drive parts such as the drive shaft.

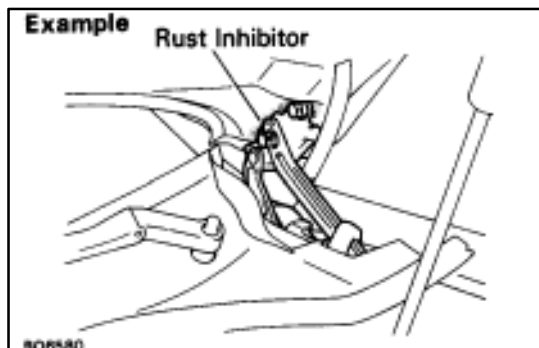

Rust Inhibitor

After removing and re-installing hinges and outer panel parts, apply rust inhibitor to the parts.

HINT: If rust inhibitor gets spilled on other parts, promptly wipe it off with a clean cloth dipped in a grease, wax and silicon remover.

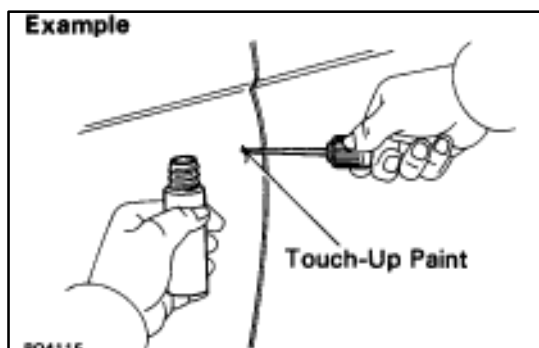

Touch-Up Paint

If a small scratch is made in the body surface, correct the scratch using touch-up paint the same color as the body color.

CLIPS

The removal and installation methods of typical clips used in body parts are shown in the table below.

HINT: If the clip is damaged during the operation, always replace it with a new clip.

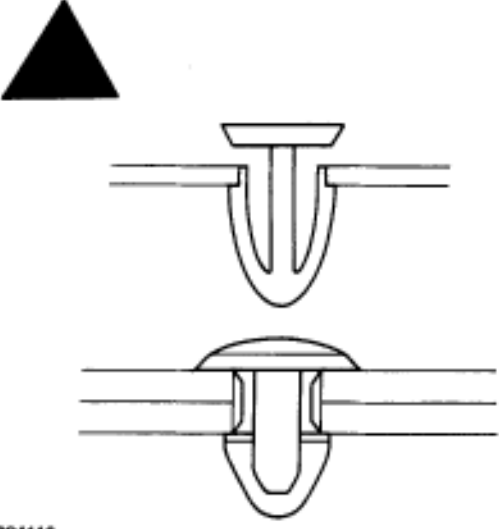
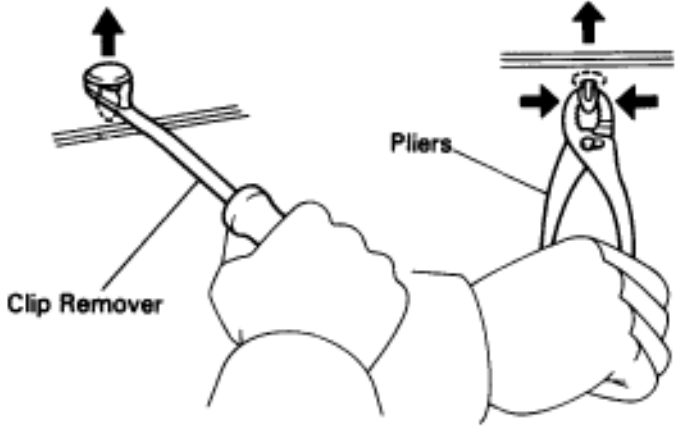
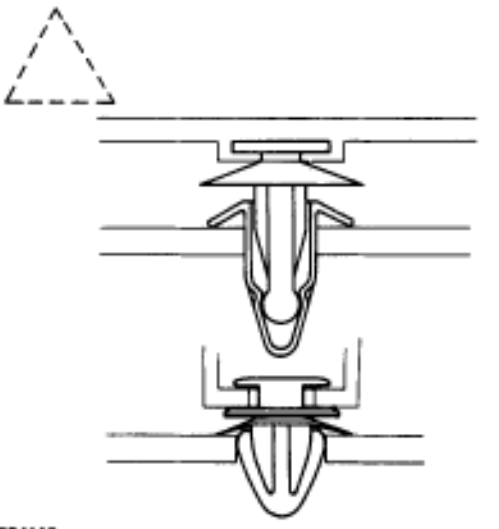
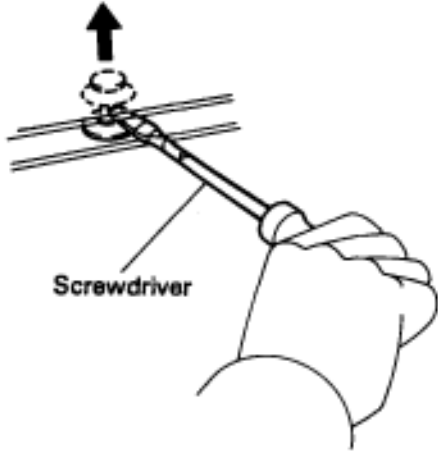
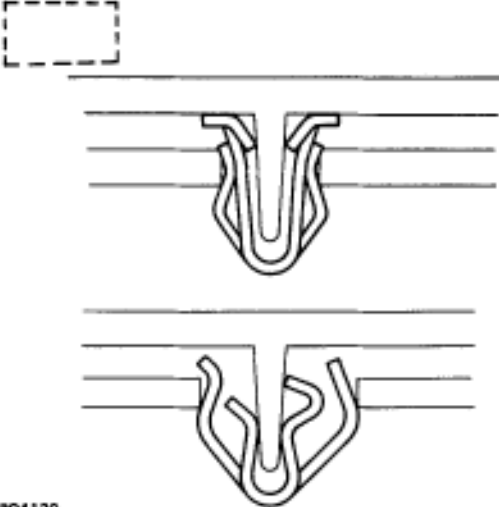
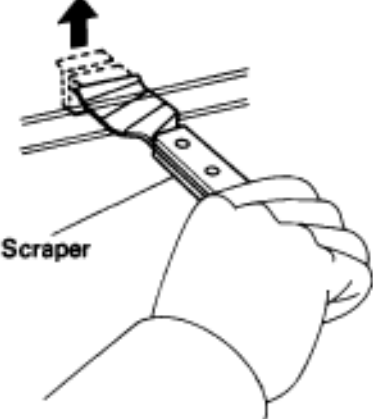
Shape (Example)	Removal/Installation
 <p>BO4116</p>	 <p>Clip Remover</p> <p>Pliers</p> <p>BO4117</p>
 <p>BO4118</p>	 <p>Screwdriver</p> <p>BO4119</p>
 <p>BO4120</p>	 <p>Scraper</p> <p>BO4121</p>

CLIPS (Cont'd)

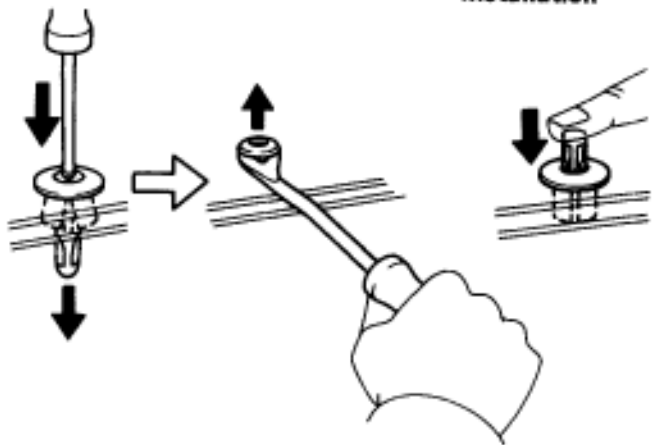
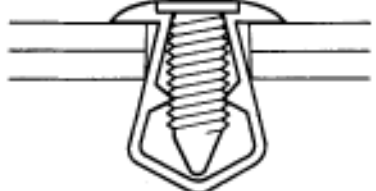
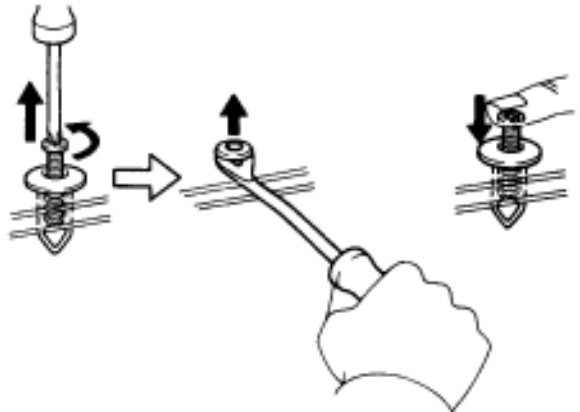
Shape (Example)	Removal/Installation
 <p>BO4122</p>	<p>Removal Installation</p>  <p>BO4123</p>
 <p>BO4124</p>	<p>Removal Installation</p>  <p>BO4125</p>

HOW TO USE THIS SECTION

Components

When the removal and reassembly of a second system is also required in order to remove and disassemble a certain system, the components are laid out in the component diagram as follows.

1. When it is necessary to remove and reassemble almost all the parts of the second system:

The component diagram of the second system is reduced in size and included inside the large component diagram within its own separate frame.

HINT: For more detail than is given in the second component diagram in the separate frame, refer to the component diagram of the applicable system.

Example:

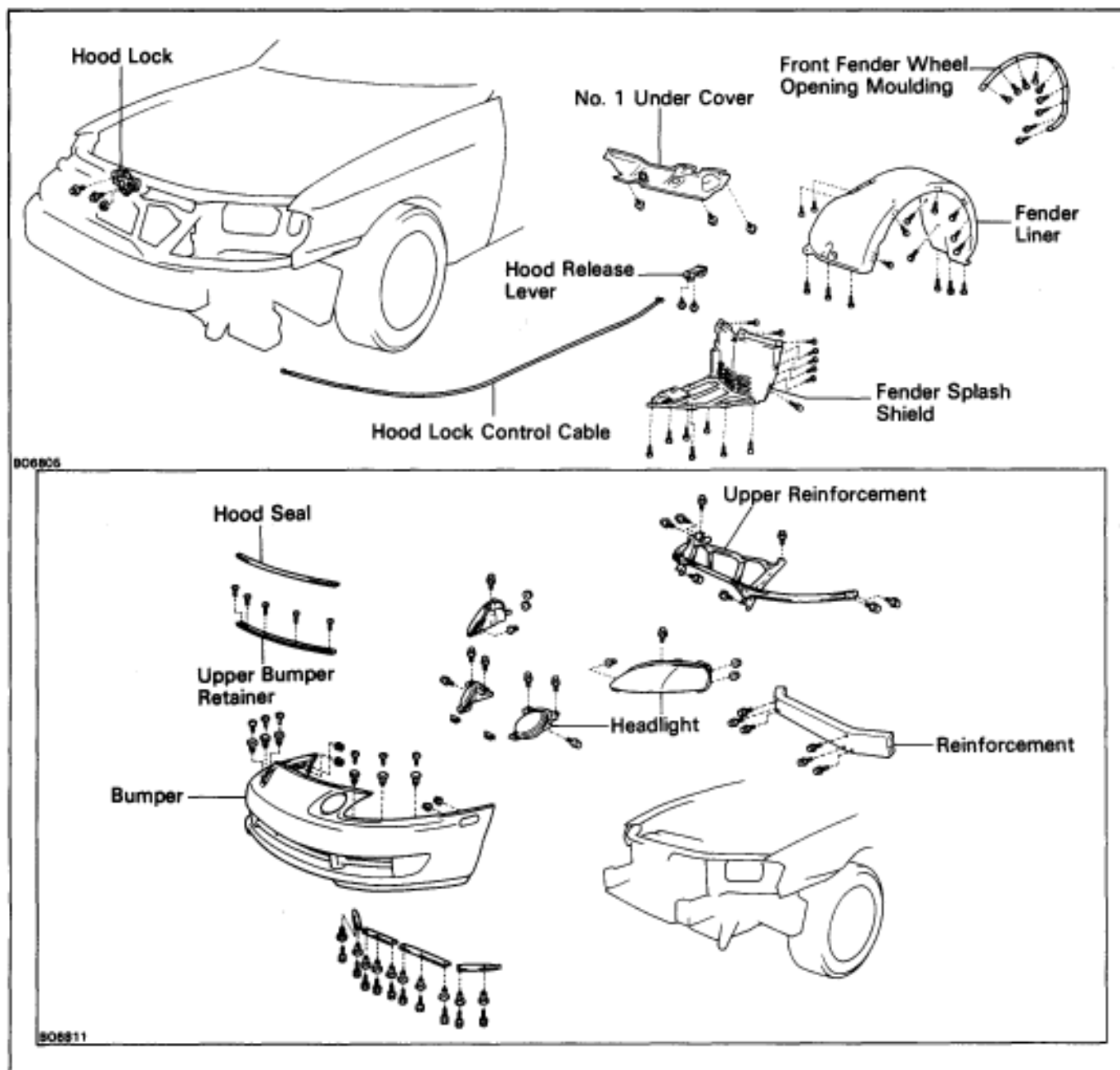

2. When the components of the second system which need to be removed are few in number and can be removed as a unit:

An abbreviated diagram of the parts and the name of the second system are included inside the larger component diagram.

HINT: For more detail than is given in the abbreviated diagram, refer to the component diagram on the page number referred to by the "See page" next to the diagram title.

Example:

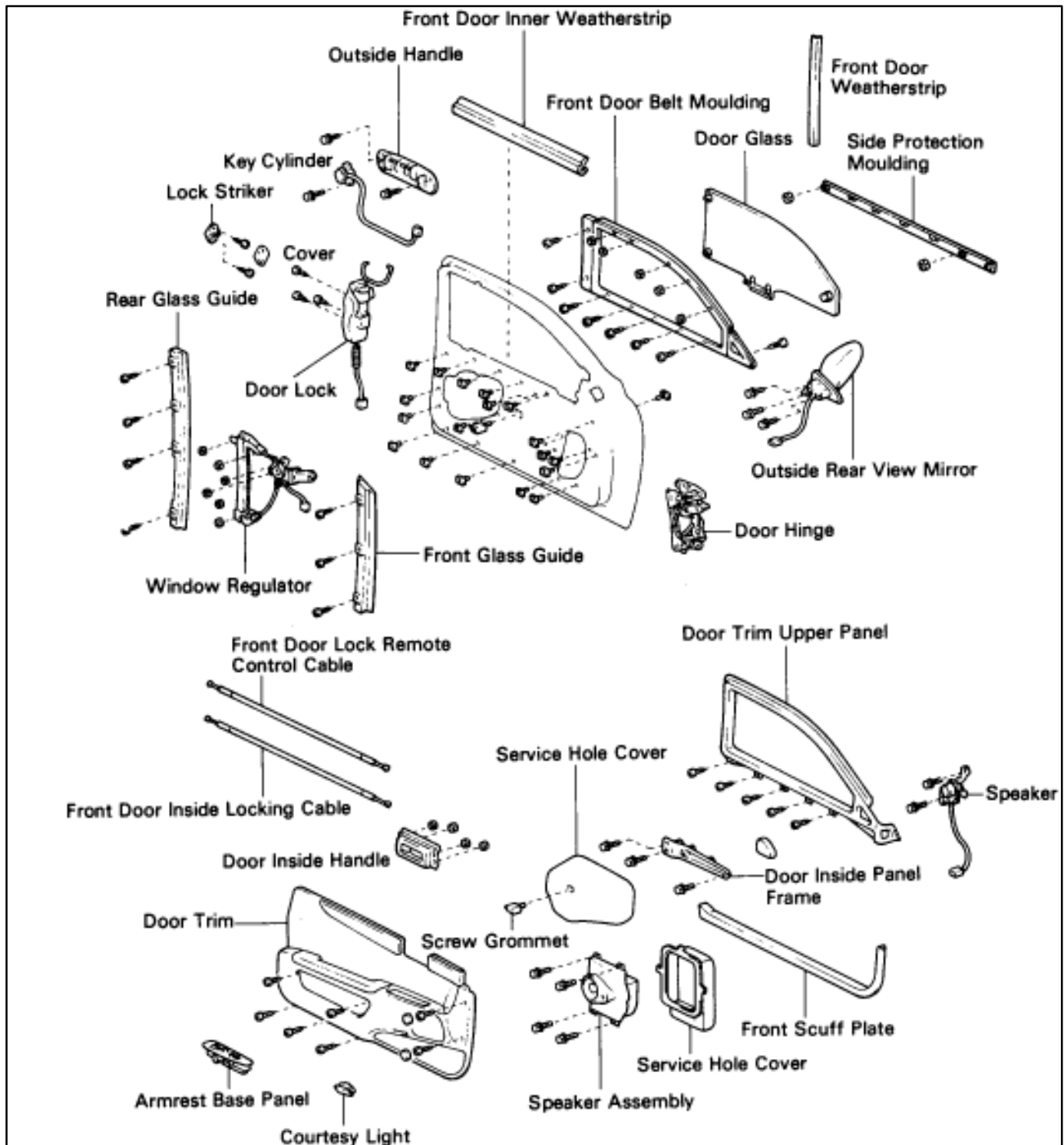

SRS AIRBAG

(See page [AB-2](#))

The LEXUS SC400 is equipped with an SRS (Supplemental Restraint System) airbag.

Failure to carry out service operations in the correct sequence could cause the airbag system to deploy, possibly leading to a serious accident.

When removal or installation of airbag parts and the yellow wire harness and connector for the airbag is necessary, refer to the precautionary notices in the AB section before performing the operation.

- Work must be started after 20 seconds or longer from the time the ignition switch is set to the LOCK position and the negative (–) terminal cable is disconnected from the battery.
(The airbag system is equipped with a back-up power source so that if work is started within 20 seconds of disconnecting the negative (–) terminal cable of the battery, the airbag may be deployed.)
- To avoid erasing the memory of each memory system, never use a back-up power supply from outside the vehicle.
- Before repairs, remove the airbag sensors if shocks are likely to be applied to the sensors during repairs.
- The front airbag sensor set bolt has been anti-rust treated. When the sensor is removed, always replace the set bolt with a new one.
- If the front airbag sensors, center airbag sensor or steering wheel pad have been dropped, or if there are cracks, dents or other defects in the case, bracket or connector, replace them with new ones.
- Never use airbag parts from another vehicle. When replacing parts, replace them with new parts.
- Do not expose the front airbag sensors, center airbag sensor or steering wheel pad directly to hot air or flames.
- The airbag system's wire harness is integrated with the cowl wire harness assembly. The wires for the airbag wire harness are encased in a yellow corrugated tube. All the connectors for the system are also a standard yellow color. If the airbag system wire harness becomes disconnected or the connector becomes broken due to an accident, etc., repair or replace it as shown on page [AB-20](#).
- The steering wheel must be fitted correctly to the steering column with the spiral cable at the neutral position; otherwise, cable disconnection and other troubles may result. Refer to page [AB-14](#) of this manual concerning correct steering wheel installation.
- When removing the steering wheel pad or handling a new steering wheel pad, it should be placed with the pad top surface facing up. In this case, the twin-lock type connector lock lever should be in the locked state and care should be taken to place it so the connector will not be damaged. (Storing the pad with its metallic surface up may lead to a serious accident if the airbag inflates for some reason.)
- Grease should not be applied to the steering wheel pad and the pad should not be cleaned with detergents of any kind.
- Store the steering wheel pad where the ambient temperature remains below 935C (2005F), without high humidity and away from electrical noise.
- Information labels are attached to the periphery of the airbag components. Follow the notices.
- When the ignition switch is at ACC or ON and the airbag warning light remains on, the center airbag sensor assembly has detected a malfunction code. (See page [AB-30](#)).