

# Luggage compartment Door Opener Main Switch and Opener Switch Circuit

## CIRCUIT DESCRIPTION

The luggage compartment door opener main switch is off when it is pushed in, and the luggage compartment door opener switch is on when it is pulled.

The ECU energizes the luggage compartment door opener motor only when the main switch and opener switch are on together.



## DIAGNOSTIC CHART

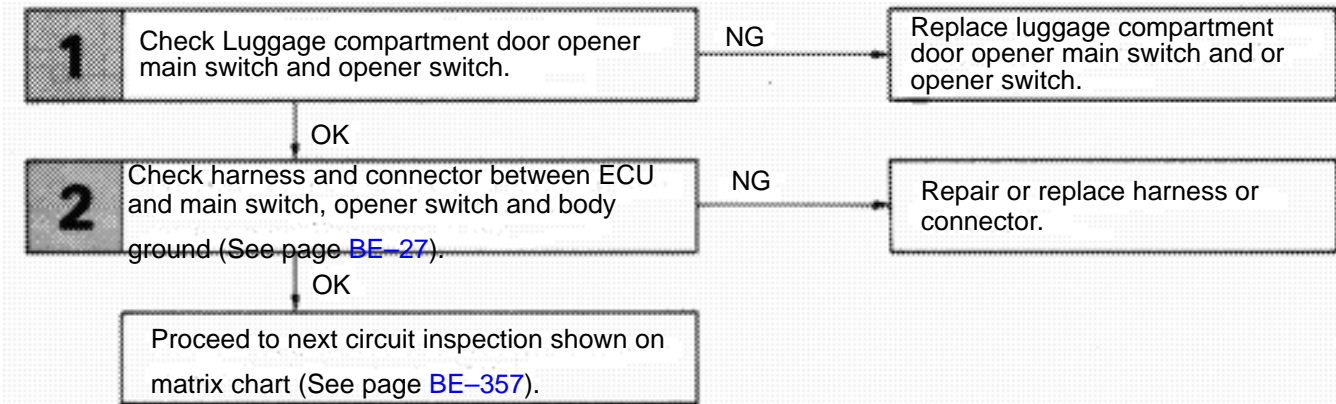

## WIRING DIAGRAM

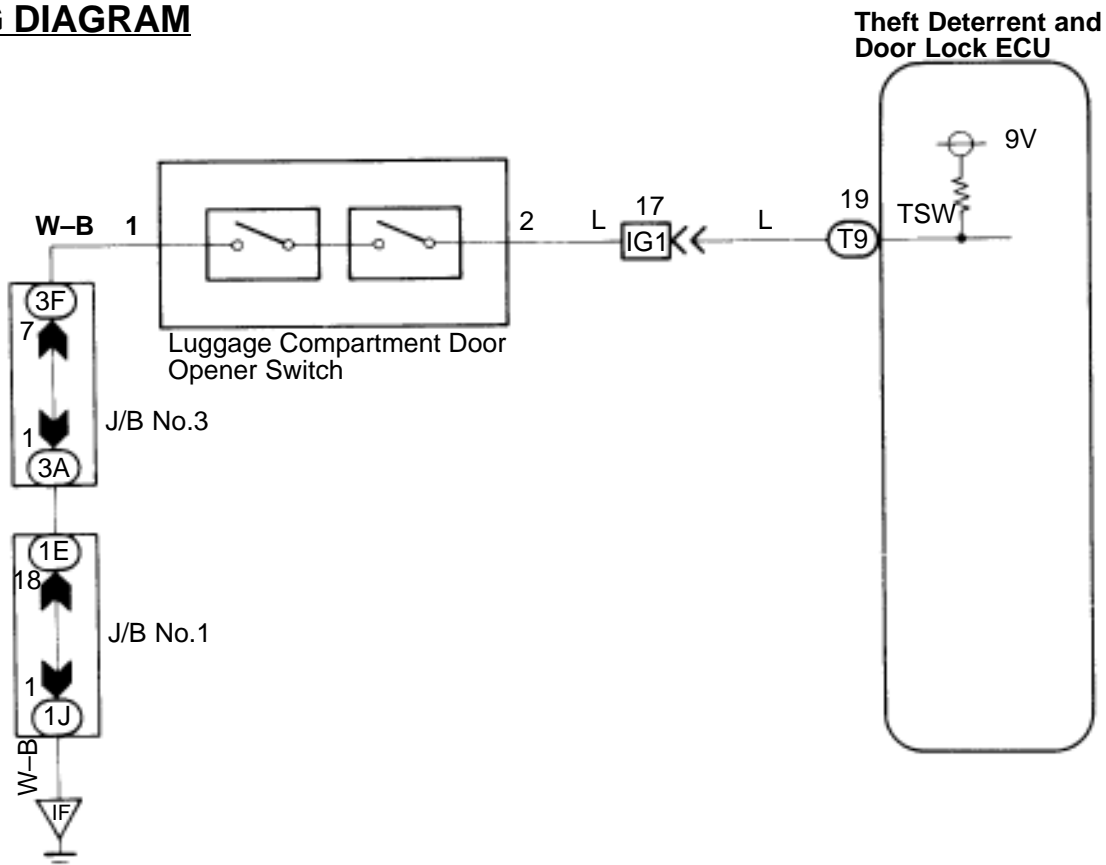

# INSPECTION PROCEDURE

## 1 Check luggage compartment door opener main switch and opener switch.

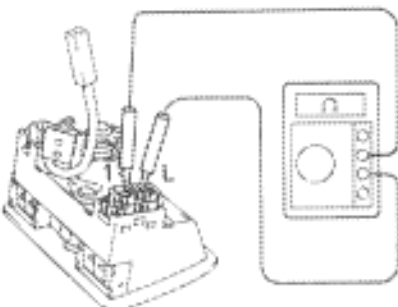
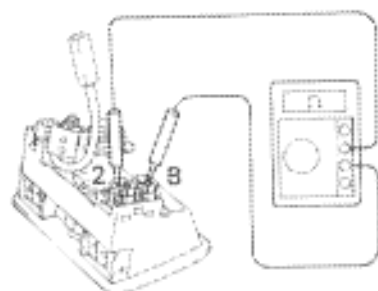
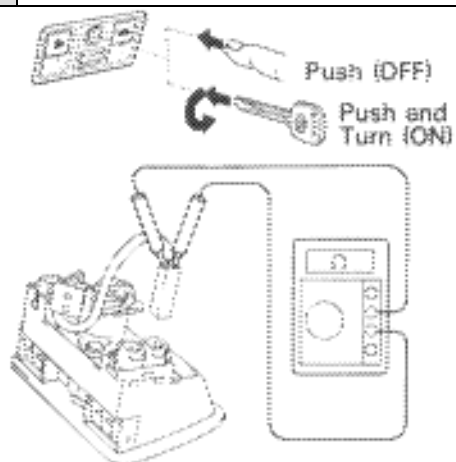

8C7884  
8E3924  
8E3923  
8E3925  
8E3925

**P** Disconnect the luggage compartment for opener main switch and opener switch connector.

**C** Check luggage compartment door opener main switch.  
Check continuity between terminals of main switch connector.

**OK**

		Continuity	
Terminal		1	2
Switch position	ON (Pushed and turn)		
	OFF (Push)		

**C** Check luggage compartment door opener switch.  
Check continuity between terminals of main switch and opener switch connector.

**OK**

		Terminal			
Switch position		2	B	1	L
ON (Pull)					
	OFF				

**OK**

**NG**

Replace luggage compartment door opener main switch and or opener switch.

## 2 Check harness and connector between ECU and main switch, opener switch and body ground (See page IN-27).

**OK**

**NG**

Repair or replace harness or connector.

Proceed to next circuit inspection shown on matrix chart (See page BE-357).