

REFRIGERANT LINES TIGHTENING TORQUE OF REFRIGERANT LINES

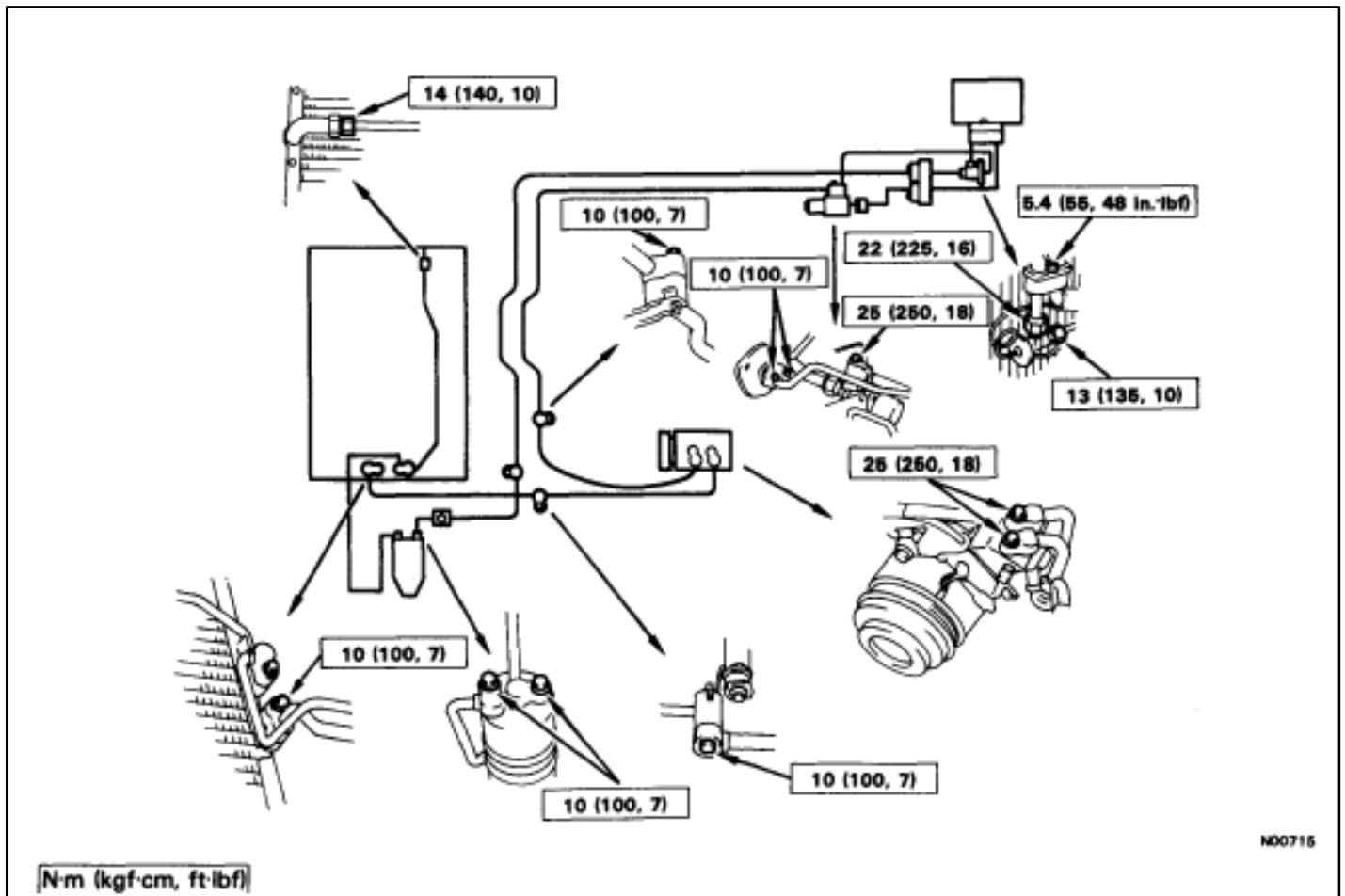

ON-VEHICLE INSPECTION

1. INSPECT HOSES AND TUBES FOR LEAKAGE

Use a gas leak tester. Replace if necessary.

2. INSPECT HOSE AND TUBE CONNECTIONS FOR LOOSENESS

REPLACEMENT OF REFRIGERANT LINES

1. RECOVER REFRIGERANT IN REFRIGERATION SYSTEM

See page [AC-16](#)

2. REPLACE FAULTY TUBE OR HOSE

NOTICE: To prevent the intrusion of moisture or dirt, caps should be placed on hose or tube ends immediately.

3. TORQUE CONNECTIONS TO SPECIFIED TORQUE

NOTICE: Connections should not be torque tighter than the specified torque.

4. EVACUATE REFRIGERATION SYSTEM AND CHARGE WITH REFRIGERANT

See page [AC-17](#)

Specified amount: 950 ± 50 g (33.44 ± 1.76 oz)

5. INSPECT FOR LEAKAGE OF REFRIGERANT

Using a gas leak tester, check for leakage of refrigerant.

6. INSPECT A/C OPERATION