

REMOVAL

1. **REMOVE ENGINE UNDER COVER AND ENGINE UNDER COVER NO.2**
2. **DRAIN ENGINE COOLANT**
(See page CO-2)

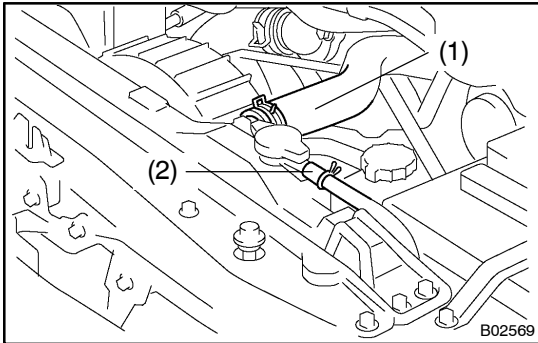

3. DISCONNECT HOSES

Disconnect these hoses:

- (1) Upper radiator hose from radiator
- (2) Radiator reservoir hose

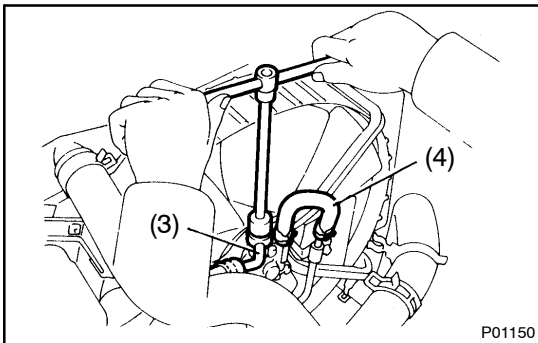

- (3) Pressure hose from hydraulic motor
- (4) Return hose from hydraulic motor

4. REMOVE BATTERY AND TRAY

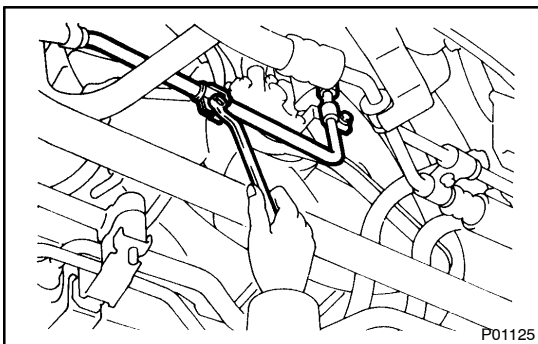

5. DISCONNECT COOLING FAN INLET PIPE FROM FAN SHROUD

Remove the 2 bolts, brackets and bushings, and disconnect the inlet pipe.

6. REMOVE COOLING FAN RESERVOIR TANK FROM FAN SHROUD

(See page CO-19)

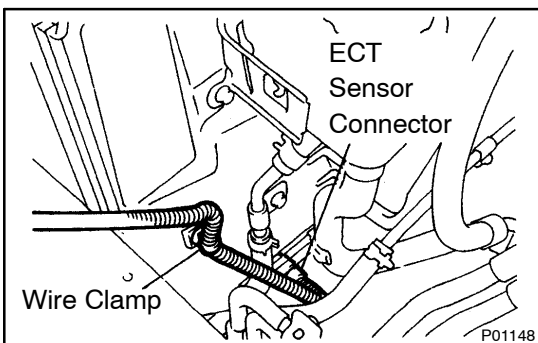

7. DISCONNECT ECT SENSOR CONNECTOR (FOR COOLING FAN)

- (a) Disconnect the ECT sensor connector.
- (b) Disconnect the wire clamp from the fan shroud.

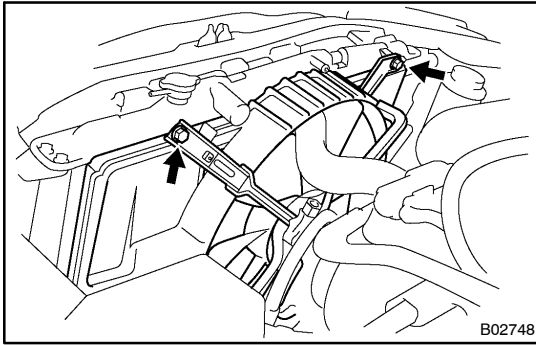
**8. REMOVE RADIATOR FAN SHROUD**

- (a) Remove the 4 bolts, and disconnect the fan shroud from the radiator.

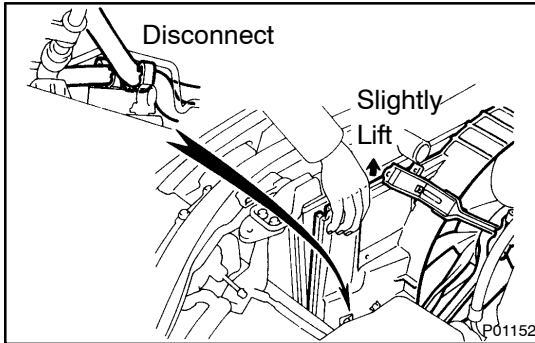

- (b) Slightly lift the fan shroud, and disconnect the 2 oil cooler hoses (for cooling fan) from the hose clamp on the fan shroud.

- (c) Remove the fan shroud.

9. REMOVE COOLING FAN FROM HYDRAULIC MOTOR

Loosen the pulley nut clockwise, and remove the nut, plate washer and fan.

10. REMOVE HYDRAULIC MOTOR FROM FAN SHROUD

Remove the 3 bolts and hydraulic motor.