

REASSEMBLY

HINT:

- Thoroughly clean all parts to be assembled.
- Before installing the parts, apply new engine oil to all sliding and rotating surfaces.
- Replace all gaskets and oil seals with new ones.

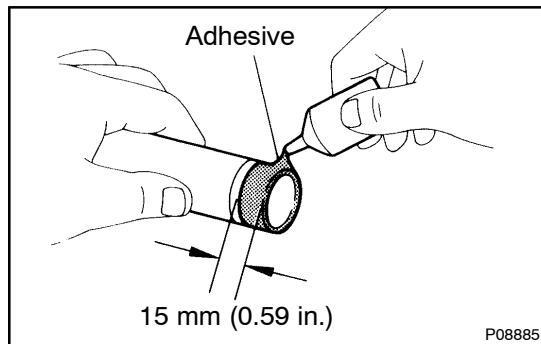

1. INSTALL SPARK PLUG TUBES

HINT:

When using a new cylinder head, spark plug tubes must be installed.

- (a) Apply adhesive to the end of the spark plug tube.

Adhesive:

Part No. 08833-00070, THREE BOND 1324 or equivalent

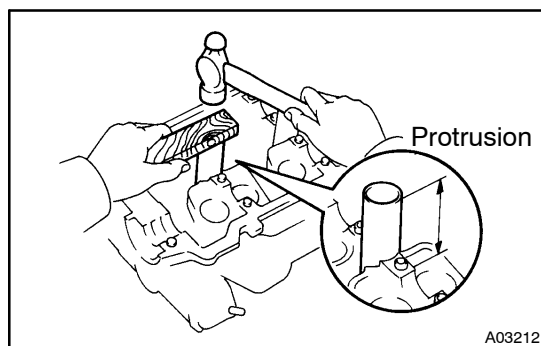

- (b) Using a wooden block and hammer, tap in a new spark tube until there is 48.4 – 49.6 mm (1.906 – 1.953 in.) protruding from the camshaft bearing cap installation surface of the cylinder head.

NOTICE:

Avoid tapping a new spark plug tube in too far by measuring the amount of the protrusion while tapping.

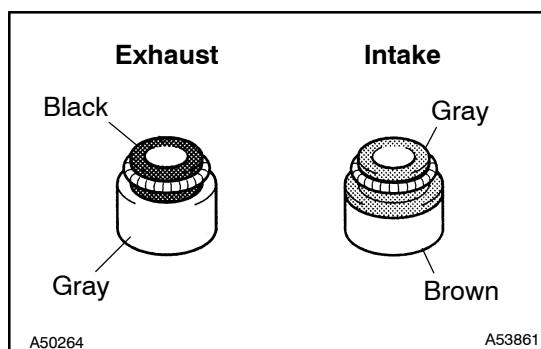

2. INSTALL VALVES

- (a) Apply a light coat of engine oil to a new oil seal.

NOTICE:

Pay close attention when installing the intake and exhaust oil seal. For example, installing the intake oil seal into the exhaust or installing the exhaust oil seal to the intake can cause installation problems later.

HINT:

The intake valve oil seal is gray/brown and the exhaust valve oil seal is black/gray.

- (b) Using SST, push in a new oil seal.

SST 09201-41020

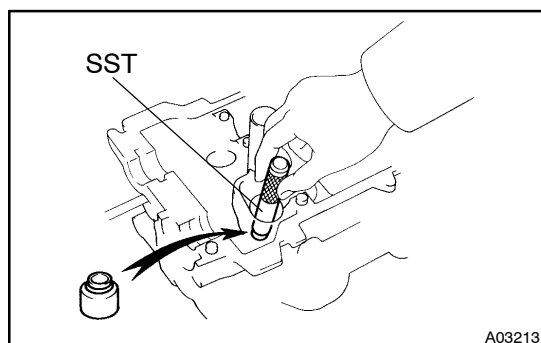

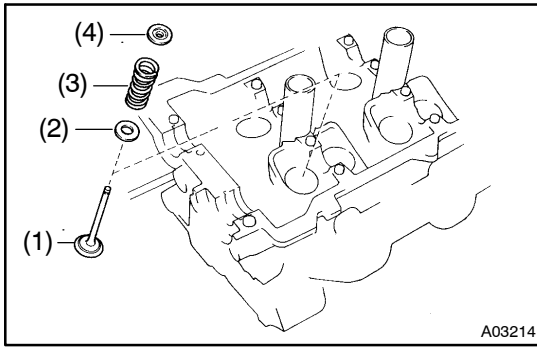

- (c) Install these parts:
- (1) Valve
 - (2) Spring seat
 - (3) Valve spring
 - (4) Spring retainer

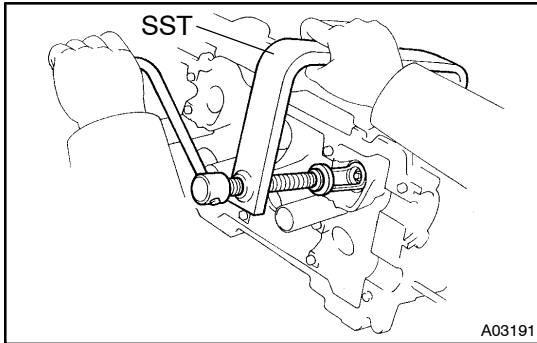

- (d) Using SST, compress the valve spring and place the 2 keepers around the valve stem.
SST 09202-70020

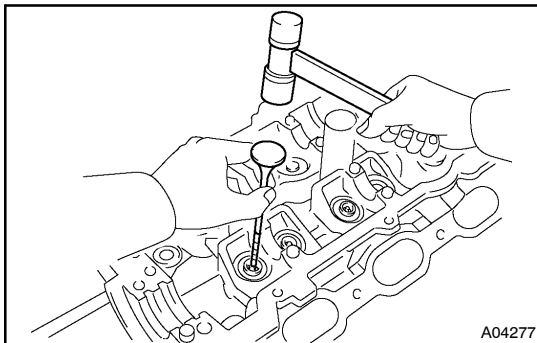

- (e) Using a plastic-faced hammer and the valve stem (not in use) tip wound with vinyl tape, lightly tap the valve stem tip to assure proper fit.

NOTICE:

Be careful not to damage the valve stem tip.

3. INSTALL SHIMS AND VALVE LIFTERS

- (a) Install the shim and valve lifter.
- (b) Check that the valve lifter rotates smoothly by hand.