

# Lower Arm with Lower Ball Joint COMPONENTS

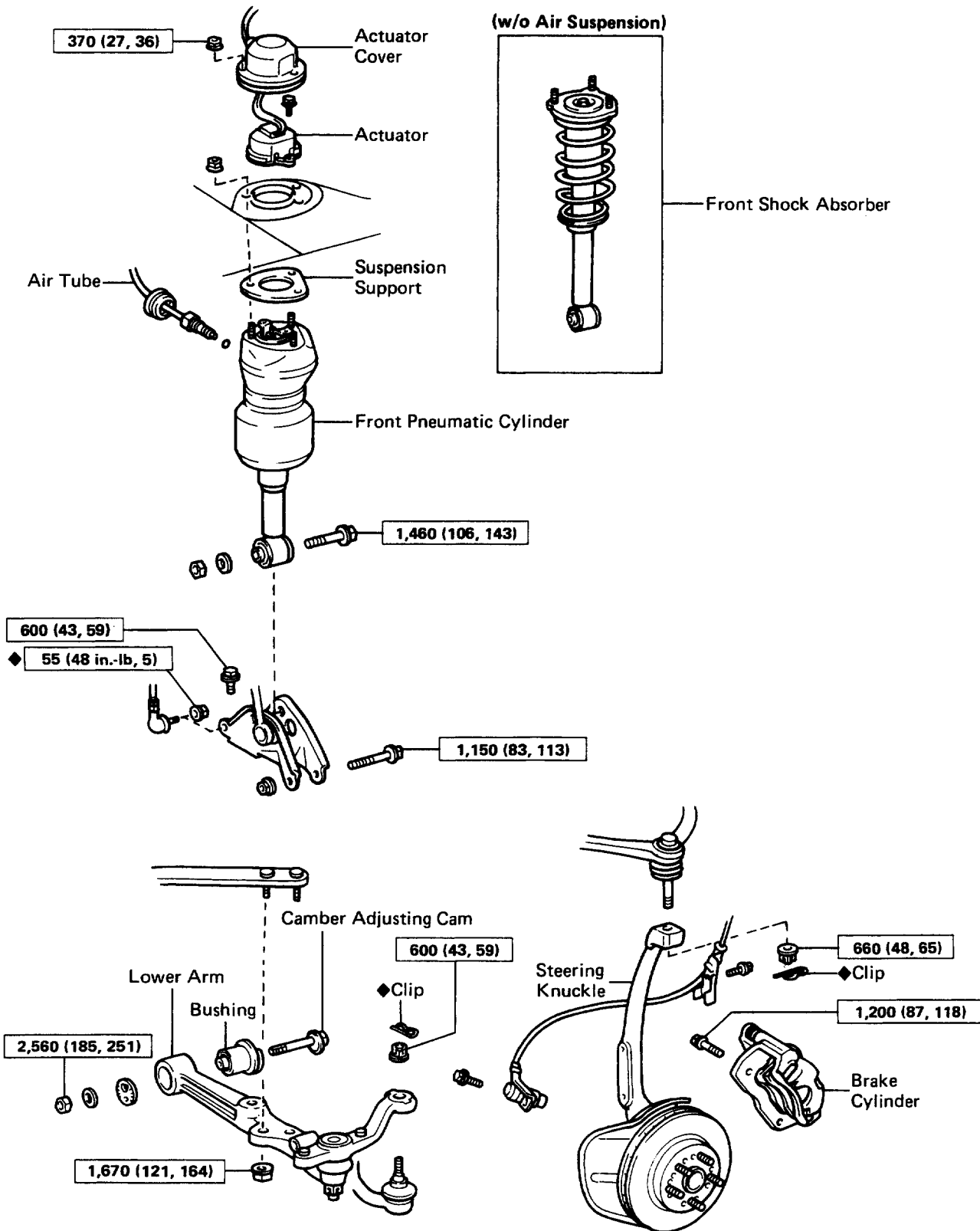

kg-cm (ft-lb, N·m) : Specified torque

◆ Non-reusable part

## REMOVAL OF LOWER ARM WITH LOWER BALL JOINT

1. REMOVE STEERING KNUCKLE WITH AXLE HUB  
(See page [SA-18](#))
- 2.-1 (w/o AIR SUSPENSION)  
REMOVE SHOCK ABSORBER WITH COIL SPRING  
(See page [SA-30](#))
- 2.-2 (w/ AIR SUSPENSION)  
REMOVE PNEUMATIC CYLINDER  
(See page [SA-36](#))
3. DISCONNECT TIE ROD FROM STEERING KNUCKLE ARM
  - (a) Remove the clip and the nut.

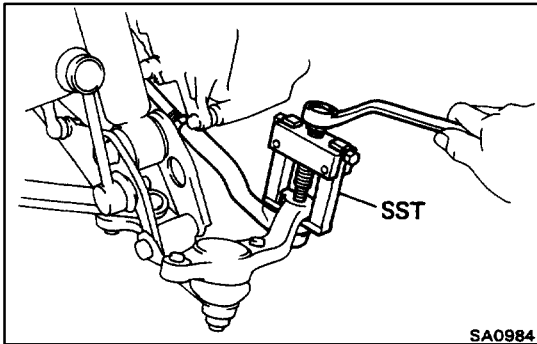
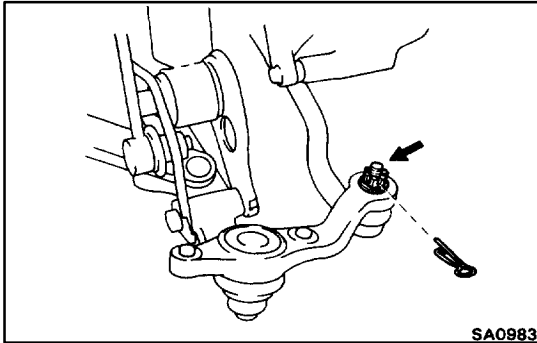

- (b) Using SST, disconnect the tie rod from the steering knuckle arm.  
SST 09628-62011

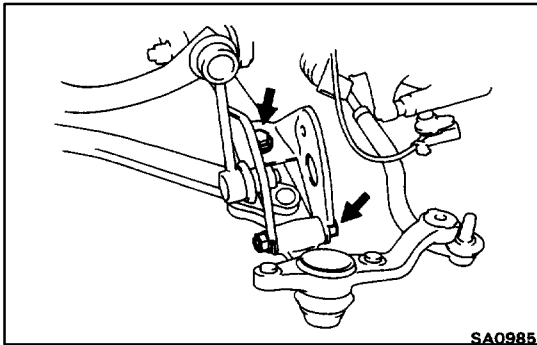

4. REMOVE SHOCK ABSORBER LOWER BRACKET

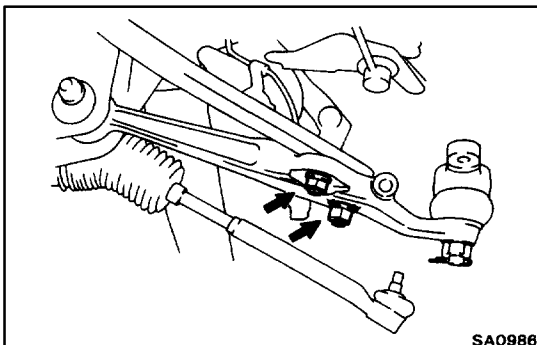

5. DISCONNECT STRUT BAR FROM LOWER ARM  
Remove the two nuts and disconnect the strut bar from the lower arm.

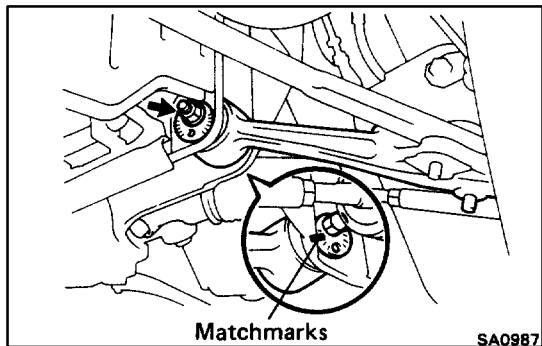

## 6. REMOVE LOWER ARM WITH LOWER BALL JOINT

- Place matchmarks on the camber adjusting cam.
- Remove the nut, the adjusting cam and the lower arm with lower ball joint.

HINT: To help remove the adjusting cam, fully pull the steering wheel toward the lower arm being removed.

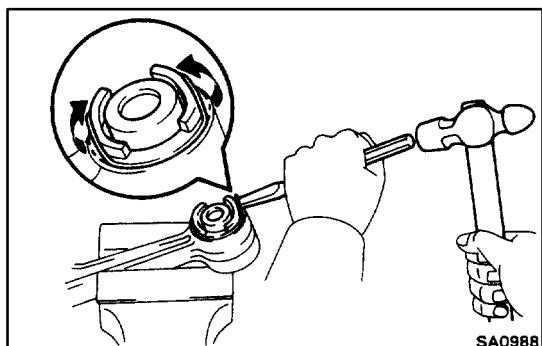

## REPLACEMENT OF LOWER ARM BUSHING

### 1. REMOVE LOWER ARM BUSHING

- Using a chisel, bend up the flange part of the bushing as shown in the illustration.

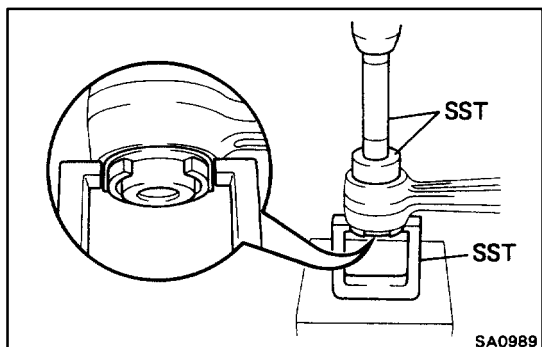

- Using SST and a press, remove the bushing.  
SST 09710-14012 (09710-00010, 09710-00050)  
09710-26010 (09710-05040)

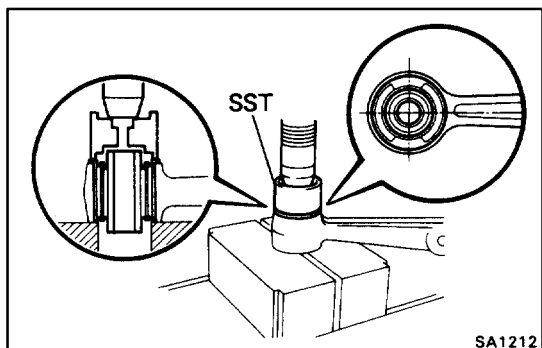

### 2. INSTALL LOWER ARM BUSHING

Using SST and a press, press a new bushing into the lower arm.

SST 09710-30050

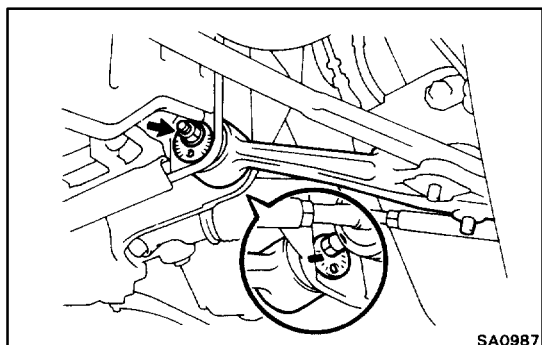

## INSTALLATION OF LOWER ARM WITH LOWER BALL JOINT

### 1. INSTALL LOWER ARM WITH LOWER BALL JOINT

Insert the camber adjusting cam from the rear side of the vehicle and temporarily tighten the nut.

HINT: Fit the two strut bar bolts into the holes in the lower arm beforehand.

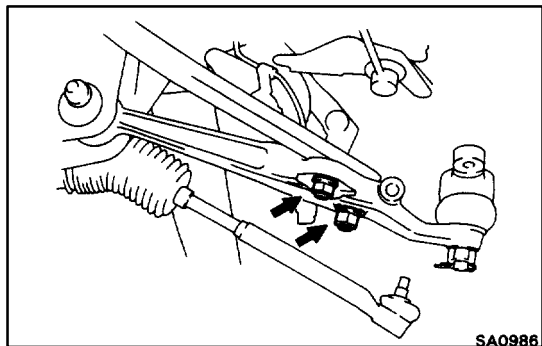

## 2. CONNECT STRUT BAR TO LOWER ARM

Connect the strut bar to the lower arm with the two nuts.

Torque: 1,670 kg-cm (121 ft-lb, 164 N-m)

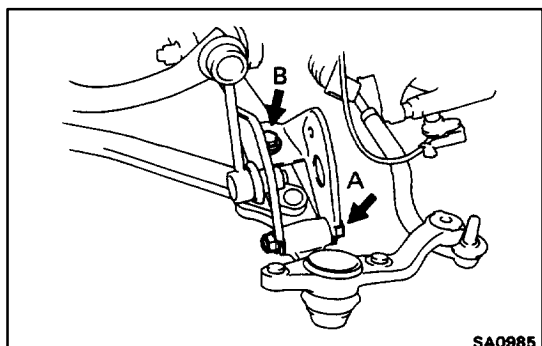

## 3. INSTALL SHOCK ABSORBER LOWER BRACKET

Install shock absorber lower bracket with two bolts and one nut.

Torque:

Bolt A 1,150 kg-cm (83 ft-lb, 113 N-m)

Bolt B 600 kg-cm (43 ft-lb, 59 N-m)

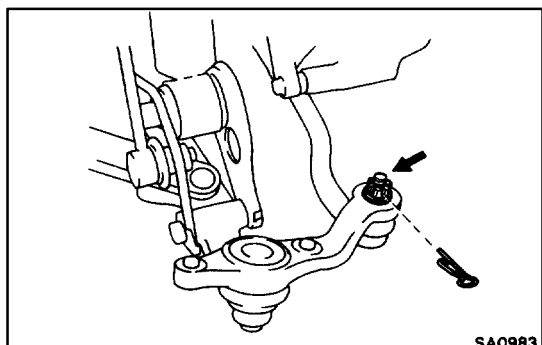

## 4. CONNECT TIE ROD TO STEERING KNUCKLE ARM

(a) Connect the tie rod to the steering knuckle arm and tighten the nut.

Torque: 600 kg-cm (43 ft-lb, 59 N-m)

(b) Install a new clip.

## 5.-1 (w/o AIR SUSPENSION)

### INSTALL SHOCK ABSORBER WITH COIL SPRING

(See page [SA-32](#))

## 5.-2 (w/ AIR SUSPENSION)

### INSTALL PNEUMATIC CYLINDER

(See page [SA-39](#))

## 6. INSTALL STEERING KNUCKLE WITH AXLE HUB

(See page [SA-23](#))

## 7. TORQUE NUT OF CAMBER ADJUSTING CAM

(a) Jack down the vehicle and stabilize the suspension.

(b) Support the lower arm with the jack and remove the wheel.

(c) Align the matchmarks and torque the nut.

Torque: 2,560 kg-cm (185 ft-lb, 251 N-m)

(d) Install the wheel and lower the vehicle.

## 8. CHECK FRONT WHEEL ALIGNMENT

(See page [SA-5](#))

